



# Intrigue

English and French Installation Manuals Available Through Your Local Dealer or Visit Our Website at [www.archgard.com](http://www.archgard.com)

Les manuels d'installation en anglais et en français sont disponibles chez votre détaillant local ou en visitant notre site Web : [www.archgard.com](http://www.archgard.com)

**INSTALLER: LEAVE THIS MANUAL WITH THE APPLIANCE.**  
**CONSUMER: RETAIN THIS MANUAL FOR FUTURE REFERENCE**

This appliance may be installed in an aftermarket permanently located, manufactured home (USA only) or mobile home where not prohibited by local codes.

This appliance is only for use with the type of gas indicated on the rating plate.  
This appliance is not convertible for use with other gases, unless a certified kit is used.

**WARNING:** If the information in these instructions is not followed exactly, a fire or explosion may result, causing property damage, personal injury or loss of life.

## WHAT TO DO IF YOU SMELL GAS:

- Do not light any appliance
- Do not touch any electrical switch: do not use any phone in your building.
- Immediately call your gas supplier from a neighbors phone.
- Follow the gas suppliers instructions.
- If you can not reach your gas supplier, call the fire department.



# DANGER



**HOT GLASS WILL CAUSE  
BURNS.**

**DO NOT TOUCH GLASS UNTIL  
COOLED.**

**NEVER ALLOW CHILDREN TO  
TOUCH GLASS.**

A barrier designed to reduce the risk of burns from the hot viewing glass is provided with this appliance and shall be installed for the protection of children and other at-risk individuals.

Do not store or use gasoline or other flammable vapors or liquids in the vicinity of this or any other appliance.

Installation and service must be performed by a qualified installer, service agency or the gas supplier

ARCHGARD FIREPLACE PRODUCTS  
7116 BEATTY DRIVE  
MISSION, BC V2V 6B4 CANADA



200-U100



# TABLE OF CONTENTS

|   |       |
|---|-------|
| <b><u>TABLE OF CONTENTS</u></b>                           |       |
| Table of Contents   | 1     |
| <b><u>SAFETY INFORMATION</u></b>                          |       |
| Safety Information  | 2     |
| <b><u>COMMONWEALTH OF MASSACHUSETTS INFORMATION</u></b>   |       |
| Commonwealth of Massachusetts Information                 | 3     |
| <b><u>SPECIFICATIONS</u></b>                              |       |
| Fireplace Dimensions                                      | 4     |
| Clearances  | 4     |
| Components List   | 5     |
| Installation Overview                                     | 5     |
| Placement Clearance Requirements                          | 5     |
| <b><u>PREPARE THE FIREPLACE</u></b>                       |       |
| Stand-Off Assembly & Installation                         | 6     |
| Horizontal Vent Heat Shield Installation                  | 7     |
| Nailing Flange Assembly & Installation                    | 7     |
| <b><u>FRAMING</u></b>                                     |       |
| Wall Enclosure Rough Opening                              | 8     |
| Minimum Finished Opening Dimensions                       | 8     |
| Horizontal Terminations                                   | 9     |
| Vertical Terminations                                     | 9     |
| <b><u>TYPICAL INSTALLATION OPTIONS</u></b>                |       |
| Typical Installation Options                              | 10    |
| <b><u>MANTEL REQUIREMENTS</u></b>                         |       |
| Mantel Requirements                                       | 11    |
| <b><u>GLASS FRAME ASSEMBLY</u></b>                        |       |
| Glass Frame Assembly Removal                              | 11    |
| Glass Frame Assembly Installation                         | 11    |
| <b><u>GAS LINE CONNECTION</u></b>                         |       |
| Gas Line Connection                                       | 12    |
| <b><u>LIGHT KIT COMPONENTS INSTALLATION (INT-200)</u></b> |       |
| Light Kit Components Installation                         | 12    |
| <b><u>VENTING</u></b>                                     |       |
| Approved Venting  | 13    |
| Horizontal Terminations                                   | 13-14 |
| Vertical Terminations                                     | 14    |
| Restrictor Setting  | 14    |
| Horizontal / Vertical Combination Terminations            | 15    |

|   |       |
|---|-------|
| <b><u>VENTING (cont.)</u></b>             |       |
| Termination Vent Cap Location             | 16    |
| Vent Termination Clearances               | 17    |
| <b><u>LOG-SET INSTALLATION</u></b>        |       |
| Log Set Installation                      | 18    |
| <b><u>Burner</u></b>                      |       |
| Burner Removal                            | 19    |
| Burner Installation                       | 20    |
| <b><u>GRILL SET</u></b>                   |       |
| Grill Set Installation                    | 21    |
| Grill Set Removal                         | 21    |
| <b><u>OPERATING INSTRUCTIONS</u></b>      |       |
| Wiring Schematics                         | 22    |
| Control System Components                 | 23    |
| System Operation                          | 24-27 |
| Lighting and Shutdown                     | 28-29 |
| Pressure Testing                          | 30    |
| <b><u>FINALIZING THE INSTALLATION</u></b> |       |
| Burner Tube Adjustment / Troubleshooting  | 31    |
| Restrictor Troubleshooting                | 32    |
| <b><u>MAINTENANCE</u></b>                 |       |
| Maintenance                               | 33    |
| <b><u>TROUBLESHOOTING</u></b>             |       |
| Troubleshooting                           | 34-35 |
| <b><u>CONVERSION KIT INSTRUCTIONS</u></b> |       |
| Conversion Kit Instructions               | 36-37 |
| <b><u>REPLACEMENT PARTS LIST</u></b>      |       |
| Replacement Parts List                    | 38    |
| <b><u>WARRANTY</u></b>                    |       |
| Warranty                                  | 39-40 |

# SAFETY INFORMATION

This fireplace has been listed by LABTEST Certification Inc to the following USA and Canada gas appliance standards

ANSI Z21.88-2014/CSA 2.33-2014 "Standard for Vented Gas Fireplace Heaters."

CAN 2.17-M19 (R2009), "Gas-Fired for Use at High Altitudes."

CAN/CSA P.4.1-09, "Testing Method for measuring Annual Efficiency

This installation must conform with local codes, or in the absence of local codes, with the *National Fuel Gas Code, ANSI Z223.1/NFPA 54*, or the *Natural Gas and Propane Installation Code, CSA B149.1*

- Installation and repair should be done only by a qualified service person. The appliance should be inspected by a qualified service person before use. Annual inspection by a qualified service person is required to maintain warranty. More frequent cleaning may be required due to excessive lint from carpeting, bedding materials, etc. It is imperative that control compartments, burners and circulation air passageways of the appliance be kept clean.
- If this appliance is installed directly on carpeting, tile or other combustible material other than wood flooring, the appliance shall be installed on a metal or wood panel extending the full width and depth of the appliance.
- Children and adults should be alerted to the hazards of high surface temperatures and should stay away to avoid burns or clothing ignition.
- Young children should be carefully supervised when they are in the same room as the appliance. Toddlers, young children and others may be susceptible to accidental contact burns. A physical barrier is recommended if there are at risk individuals in the house. To restrict access to a fireplace or stove, install an adjustable safety gate to keep toddlers, young children and other at risk individuals out of the room and away from hot surfaces.
- Clothing or other flammable material should not be placed on or near the appliance.
- Adequate accessibility clearances for servicing and proper operation must be maintained.
- This appliance must not share or be connected to a chimney flue serving any other appliance.
- Keep area around the appliance clear of combustible materials, gasoline and other flammable vapor and liquids.
- The flow of combustion and ventilation air must not be obstructed.
- Due to high temperatures the appliance should be located out of traffic and away from furniture and draperies.
- The glass front or any part removed for servicing the appliance must be replaced prior to operating the appliance. Work should be done by a qualified service technician.
- Clean glass only when cool and only with non-abrasive cleansers.
- **WARNING: DO NOT OPERATE APPLIANCE WITH THE GLASS/FRAME ASSEMBLY REMOVED, CRACKED OR BROKEN. REPLACEMENT OF THE GLASS SHOULD ONLY BE PERFORMED BY A LICENSED OR QUALIFIED SERVICE PERSON.**
- The glass assembly, shall only be replaced as a complete unit, as supplied by Archgard Industries Ltd.  
**DO NOT SUBSTITUTE ANY MATERIALS**
- Do not strike or slam glass assembly.
- Any safety screen or guard removed for servicing the appliance must be replaced prior to operating the appliance.
- Under no circumstances should any solid fuel (wood, coal, paper or cardboard etc.) be used in this appliance.
- Keep burner and control compartment clean.
- Do not use this fireplace if any part has been under water. Immediately call a qualified service technician to inspect this appliance and to replace any part of the control system and any gas control which has been under water.

# COMMONWEALTH OF MASSACHUSETTS REQUIREMENTS

## NOTE

The following requirements reference various Massachusetts and national codes not contained in this manual.

For all sidewall horizontally vented gas fueled equipment installed in every dwelling, building or structure used in whole or in part for residential purposes, including those owned or operated by the Commonwealth and where the side wall exhaust vent termination is less than (7) feet above finished grade in the area of the venting, including but not limited to decks and porches, the following requirements shall be satisfied:

## INSTALLATION OF CARBON MONOXIDE DETECTORS

At time of installation of side wall horizontally vented gas fueled equipment, the installing plumber or gas-fitter shall observe that a hard wired carbon monoxide detector with an alarm and battery back-up is installed on the floor level where the gas equipment is to be installed. In addition, the installing plumber or gas-fitter shall observe that a battery operated or hard wired carbon monoxide detector is installed on each additional level of the dwelling, building or structure served by the side wall horizontal vented gas fueled equipment. It shall be the responsibility of the property owner to secure the services of qualified licensed professionals for the installation of hard wired carbon monoxide detectors.

In the event that the side wall horizontally vented gas fueled equipment is installed in a crawl space or attic, the hard wired carbon monoxide detector with alarm and battery back-up may be installed on the next adjacent floor level.

In the event that the requirements of this subdivision can not be met at the time of completion of installation, the owner shall have a period of thirty (30) days to comply with the above requirements; provided, however, that during said thirty (30) day period, a battery operated carbon monoxide detector with an alarm shall be installed.

## APPROVED CARBON MONOXIDE DETECTORS

Each carbon monoxide detector as required in accordance with the above provisions shall comply with NFPA 720 and be ANSI/UL 2034 listed and IAS certified.

## SIGNAGE

A metal or plastic identification plate shall be permanently mounted to the exterior of the building at a minimum of eight (8) feet above grade directly in line with the exhaust vent terminal for the horizontally vented gas fueled heating appliance or equipment. The sign shall read, in print no less the one-half inch (1/2) in size, "GAS VENT DIRECTLY BELOW. KEEP CLEAR OF ALL OBSTRUCTIONS".

## INSPECTION

The state or local gas inspector of the side wall horizontally vented gas fueled equipment shall not approve the installation unless, upon inspection, the inspector observes carbon monoxide detectors and signage installed in accordance with the provisions of 248 CMR 5.08 (2) (a) 1 through 4.

## EXEMPTIONS

The following equipment is exempt from 248 CMR 5.08 (2) (a) 1 through 4: The equipment listed in Chapter 10 entitled "Equipment Not Required To Be Vented" in the most current edition of NFPA 54 as adopted by the Board; and Product Approved side wall horizontally vented gas fueled equipment installed in a room or structure separate from the dwelling, building or structure used in whole or in part for residential purposes.

## MANUFACTURER REQUIREMENTS - GAS EQUIPMENT VENTING SYSTEM PROVIDED

When the manufacturer of Product Approved side wall horizontally vented gas equipment provides a venting system design or venting system components with the equipment, the instructions provided by the manufacturer for installation of the equipment and the venting system shall include:

Detailed instructions for the installation of the venting system design or the venting system components; and

A complete parts list for the venting system design or venting system.

## MANUFACTURER REQUIREMENTS - GAS EQUIPMENT VENTING SYSTEM NOT PROVIDED

When the manufacturer of Product Approved side wall horizontally vented gas equipment does not provide the parts for venting the flue gases, but identifies "special venting systems", the following requirements shall be satisfied by the manufacturer:

The referenced "special venting systems" instructions shall be included with the appliance or equipment installation instructions and;

The "special venting systems" shall be Product Approved by the Board, and the instructions for that system shall include a parts list and detailed installation instructions.

A copy of all installation instructions for all Product Approved side wall horizontally vented gas fueled equipment, all venting instructions, all parts lists for venting instructions, and/or all venting design instructions shall remain with the appliance or equipment at the completion of the installation.



# SPECIFICATIONS

## FIREPLACE DIMENSIONS

|                      | DESCRIPTION | Height | Width  | Back Width | Depth  | Opening Width | Glass Frame Height | Stand-off Height | Front to Vent Center (Vert. Term.) | Floor to Vent Center (Hor. Term.) | Front to Angled Back |
|----------------------|-------------|--------|--------|------------|--------|---------------|--------------------|------------------|------------------------------------|-----------------------------------|----------------------|
| FIREPLACE DIMENSIONS | INCHES      | 34-1/2 | 40-7/8 | 30-7/8     | 19-3/8 | 35-1/2        | 26-5/8             | 10               | 16-1/8                             | 32-3/8                            | 8-1/8                |
|                      | MILLIMETERS | 876    | 1038   | 785        | 493    | 902           | 676                | 254              | 410                                | 848                               | 210                  |

### WARNING

All stand-off brackets must be attached to fireplace. Do not remove. Top stand-off brackets are not load bearing. Non-combustible zone: Top stand-offs provide 10" (254mm) minimum clearance to header. Use only non-combustible material in this area for entire width of fireplace. Do not use wood, sheetrock etc. in this zone. Other clearances apply. All clearances must be maintained.

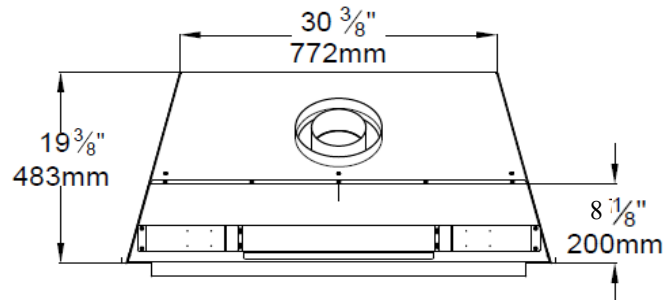
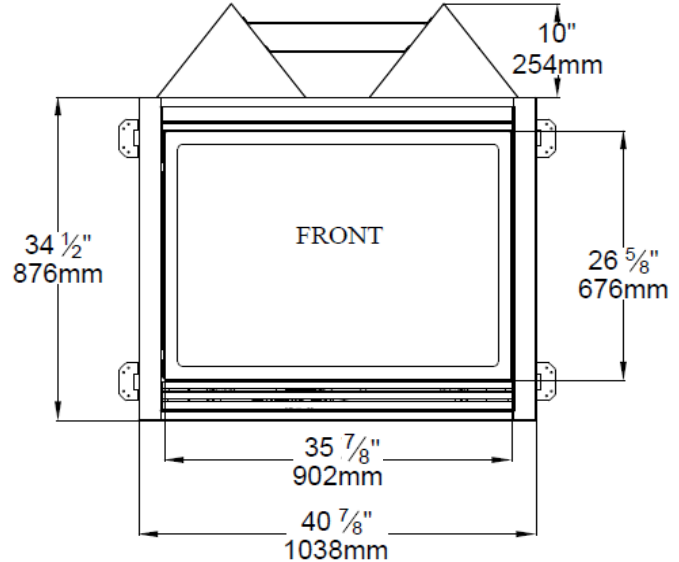
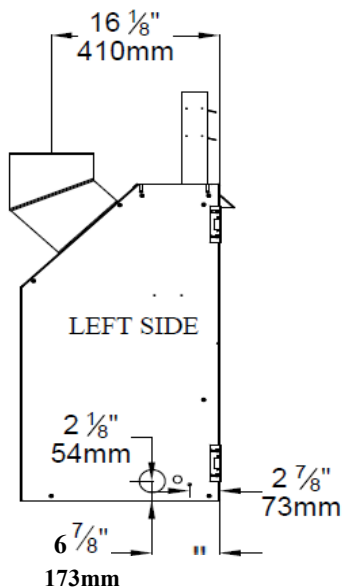
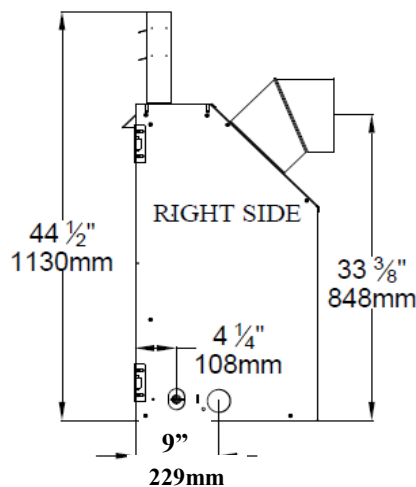

### CLEARANCES

|   |                 |
|---|-----------------|
| Top of unit face to header (cement board may be used in this area). | 10" (254mm)     |
| From unit left & right sides and back                               | 1/2" (13mm)     |
| To flooring   | 0" (0mm)        |
| Unit top to ceiling   | 31" (787mm)     |
| Side of unit face to adjacent sidewall                              | 3" (76mm)       |
| Mantel 9" (229mm) deep from top of fireplace                        | 12-1/2" (318mm) |
| Top of fireplace to 1" (25mm) trim                                  | 10" (254mm)     |

Figure 4a

# SPECIFICATIONS

## UF0100 COMPONENTS LIST

| DESCRIPTION                     |
|---------------------------------|
| IPI Control Board Assembly      |
| Manual Gas Shut-off Valve       |
| Burner Assembly                 |
| Refractory Set (back and sides) |
| Log Package                     |
| Glass Frame Assembly            |
| Double Receptacle Assembly      |
| 4 pc. Grill Assembly            |
| Remote Control                  |
| Light Kit                       |
| Fan Kit                         |

## INSTALLATION OVERVIEW

### NOTE

The qualified installer should follow the procedure best suited for the installation.

### NOTE

This appliance must be electrically grounded and connected in accordance with local codes, or in the absence of local codes, with the National Electrical Code, ANSI/NFPA 70 Current Edition, or the Canadian Electrical Code CSA C22.1.

1. Frame an opening for the fireplace, allowing for vent installation (top or rear) and type of installation (corner or flat wall application).
2. If masonry (optional) is used, prepare foundation for the masonry load. A lintel is required to support the added weight above fireplace.
3. Attach nailing flanges to fireplace.
4. Insert fireplace into framing.
5. Install hearth (if applicable).
6. Complete electrical hook-up. Install any standard or optional electrical components at this time.
7. Complete gas line installation.
8. Complete venting installation.
9. Secure fireplace to flooring through holes in outer box bottom and to framing with nailing flanges. Verify all clearances at this point.
10. Install facing material, mantel or cabinetry, allowing room for optional full face doors, if applicable.
11. Install logs.
12. Install grills and optional decorative doors / faces.
13. Verify proper operation of fireplace and all components.

## PLACEMENT CLEARANCE REQUIREMENTS

- This fireplace must be installed on a level surface capable of supporting the fireplace and venting.
- Fireplace must be placed directly on wood or non-combustible surface (not linoleum or carpet) extending entire depth and width of fireplace.
- Due to high surface temperatures, fireplace should be located out of traffic and away from furniture and draperies.
- This fireplace may be installed in a bedroom.
- Please be aware of the large amount of heat this fireplace will produce when determining a location.

# PREPARE THE FIREPLACE

## STAND-OFF ASSEMBLY & INSTALLATION

### WARNING

Top stand-off brackets and stand-off heat shields must be attached to fireplace. Do not remove. These items are not load bearing.

Non-combustible zone: Stand-offs provide 10" (254mm) minimum clearance to header. Use only non-combustible material in this area for entire width of fireplace. Do not use wood, sheetrock etc. in this zone. Other clearances apply. All clearances must be maintained.

Top stand-off brackets and stand-off heat shields are attached to fireplace top in a flat state for shipping.

1. Remove and save (4) screws securing stand-off heat shields and stand-off brackets, and (4) screws located under these items.
2. Form stand-off brackets as shown and re-attach to fireplace using screws previously removed.
3. Form stand-off heat shields and attach to stand-off brackets using (8) screws provided in components packet. (Stand-off heat shield flanges face up and to front of fireplace).

STAND-OFF BRACKETS AS SHIPPED

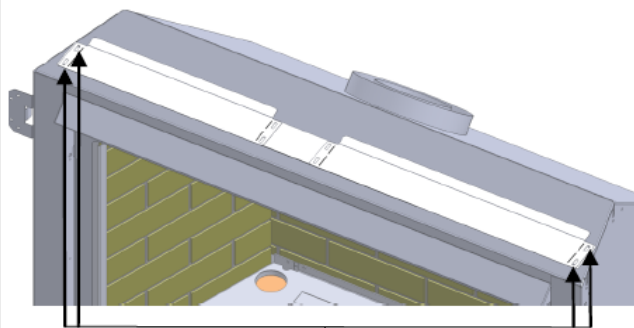

REMOVE SCREWS SECURING STAND-OFF BRACKETS

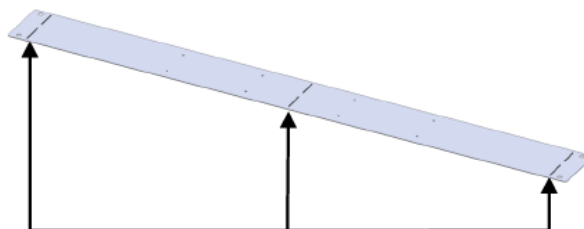

FORM STAND-OFF BY BENDING AT PERFORATIONS

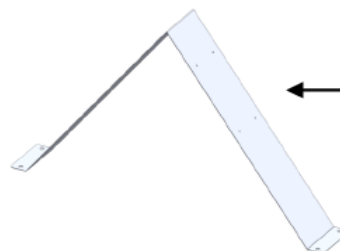

FORMED STAND-OFF

STAND-OFF BRACKETS  
INSTALLED



ALIGN HOLES IN FORMED STAND-OFFS WITH HOLES IN FIREPLACE TOP. SECURE WITH (4) SCREWS.

STAND-OFF HEAT  
SHIELDS INSTALLED

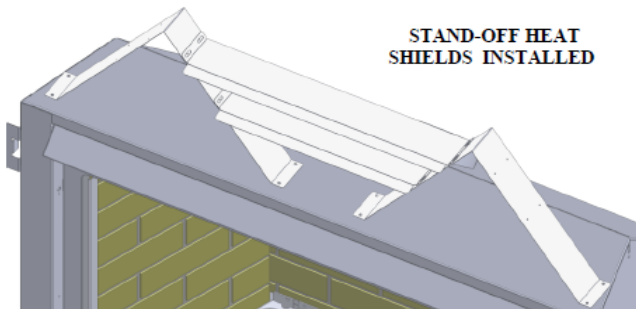

ALIGN HOLES IN FORMED STAND-OFF HEAT SHIELDS WITH HOLES IN STAND-OFF BRACKETS. SECURE WITH (8) SCREWS.

Figure 6a



# PREPARE THE FIREPLACE

## HORIZONTAL VENT HEAT SHIELD INSTALLATION

### IMPORTANT

The horizontal vent heat shield must be installed when using a 45-degree elbow to horizontally position the vent system.  
**EXCEPTION:** Corner installations

1. Loosen, but do not remove center three screws at back of fireplace as shown.
2. Bend horizontal heat shield at perforation to a 45° angle. Slide (3) slots on horizontal vent heat shield under loosened screws. Re-tighten screws.

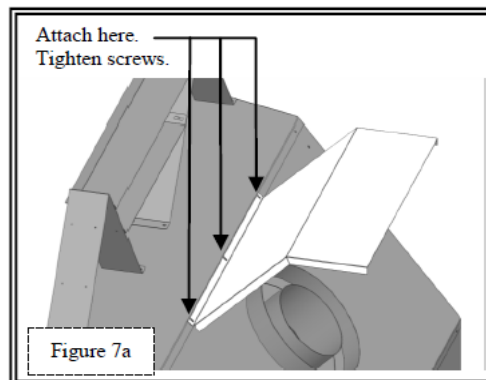

## NAILING FLANGE ASSEMBLY & INSTALLATION

1. Remove (4) nailing flanges from fireplace sides.
2. With the 1/2" (13mm) stand-offs on nailing flanges facing away from fireplace, align nailing flange with holes on outside corners of fireplace. Secure with screws through slots in nailing flanges (additional screws provided in components packet).
3. Bend perforation on nailing flange until parallel with fireplace face. Do not bend toward fireplace face.
4. Position framing stud against 1/2" (13mm) stand-off (located on backside of nailing flange). Secure with nails or screws.

### NOTE

Depending on facing material, tabs can be adjusted forward or back wards up to 1/2" (13mm).

### CAUTION

Never permanently remove these assemblies from fireplace - they must be secured in place regardless of finish material used.

When installed, nailing flanges provide minimum 1/2" (13mm) clearance from fireplace sides.

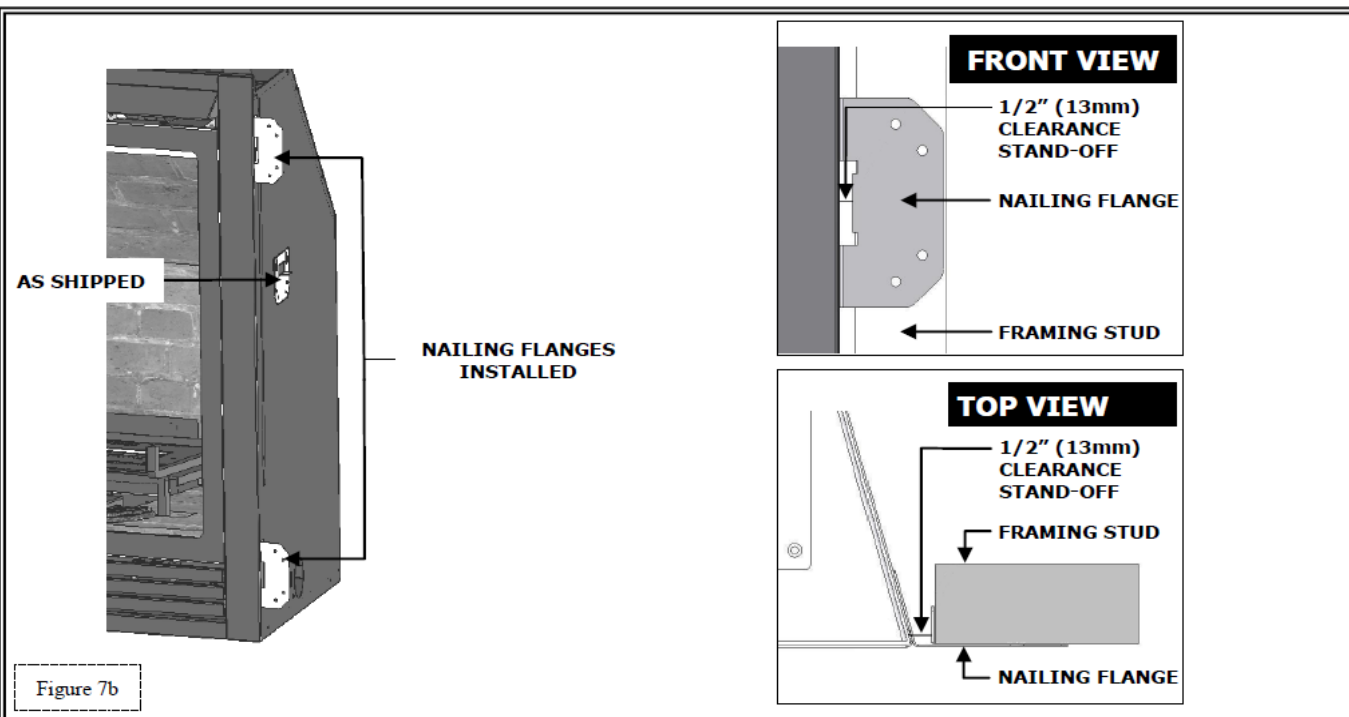

# FRAMING

## WALL ENCLOSER ROUGH OPENING

### IMPORTANT

Framing dimensions should allow for wall covering thickness and fireplace facing materials. If using a hearth, adjust rough opening size as necessary to maintain at least minimum clearance requirements.  
Non-combustible facing material may be applied over (but not directly to) fireplace face. This will prevent facing material from falling off due to heat expansion. Do not obstruct the flow of ventilation air.

## MINIMUM FINISHED OPENING DIMENSIONS

**HORIZONTAL TERMINATION:** 44-1/2" (1130mm) HIGH x 41-7/8" (1051mm) WIDE x 21-1/2" (546mm) DEEP.  
1/2" (13mm) clearance back and sides of fireplace must be maintained.

**VERTICAL TERMINATION:** 44-1/2" (1130mm) HIGH x 41-7/8" (1051mm) WIDE x 21-1/2" (546mm) DEEP.  
1/2" (13mm) clearance back and sides of fireplace must be maintained.

### NOTE

Provide adequate clearance in front of fireplace to operate lower grill, open and close optional full door face doors, access Components, installation of gas line, fan, etc. See figure 8b

### WARNING

**PROVIDE ADEQUATE CLEARANCES AROUND AIR OPENINGS INTO THE COMBUSTION CHAMBER**  
**DO NOT OBSTRUCT UPPER AND LOWER GRILL OPENINGS. ROOM AIR ENTERS THROUGH LOWER PASSAGE, IS HEATED AND EXITS THROUGH UPPER PASSAGE. BLOCKING THESE PASSAGES MAY RESULT IN OVERHEATING,**

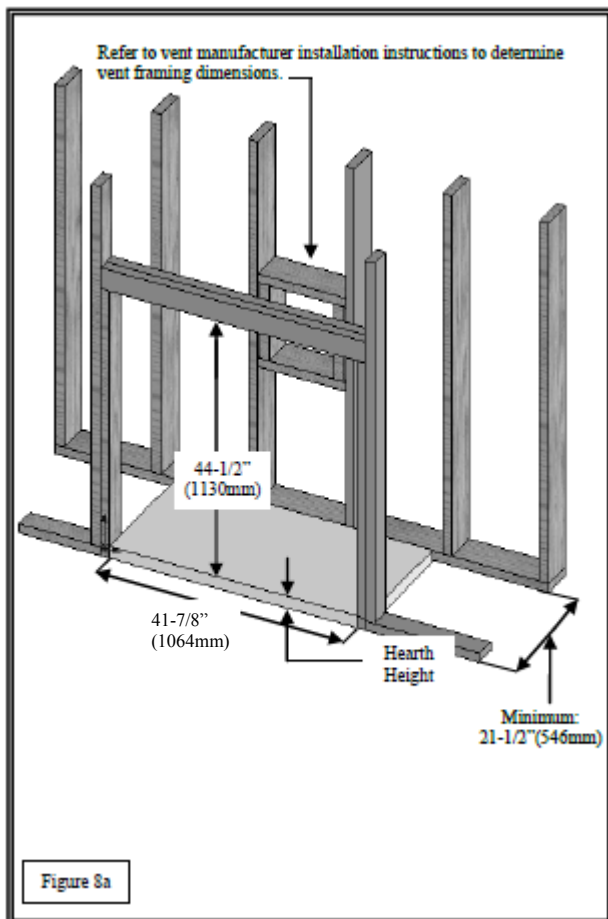

Figure 8a

## OPTIONAL FULL DOOR FACE DIMENSIONS

If installing an optional full door face, please refer to below for full face dimensions before applying facing material.

### NOTE

Consider height of hearth finish material (stone, brick, marble etc.) when building fireplace platform. Bottom of fireplace must be level with finished hearth to allow for lower grill operation and proper fit of optional decorative full door faces.  
1/2" (13mm) side overlap applies to both sides of face. Illustrations show True Dimensions. We recommend 1/4" (6mm) clearance on all sides to allow for uneven finish material.

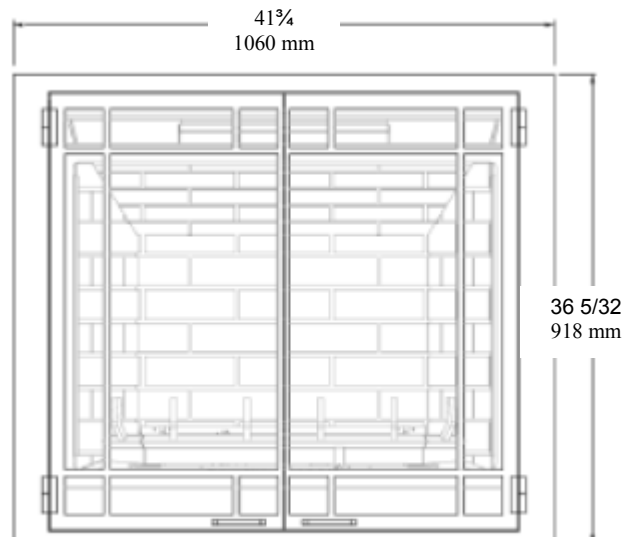

Figure 8b

## FRAMING

Determine exact position of your fireplace, including hearth height, width, and depth (if applicable). If possible, place fireplace in such a manner that vent termination will be between two studs, eliminating the need for additional framing.

If masonry is to be used (optional), prepare the necessary foundation for the masonry load. When masonry construction is used, a lintel must be used over top of fireplace to support the added weight.

Build hearth to desired size and height. If a hearth extension is desired, combustible material may be used.

### NOTE

Consider height of hearth finish material (stone, brick etc.) when building fireplace platform. Bottom of fireplace must be level with finished hearth to allow for lower grill operation and proper fit of optional decorative full door faces.

### WARNING

Install fireplace on hard metal or wood surface extending the full width and depth of fireplace.  
Minimum platform size: 41-7/8" (1064mm) x 19-3/8" (493mm) deep.

### FIRE HAZARD

DO NOT install directly on carpet, vinyl, or any combustible material other than wood.

### IMPORTANT

Vent cap location must be in compliance with guidelines on page 16 of this manual.

### WARNING

DO NOT RECESS VENT CAP INTO WALL OR SIDING.

## HORIZONTAL TERMINATIONS

Follow vent pipe manufacturer's installation instructions for horizontal terminations. Include required vent manufacturer's wall pass-thru clearances when determining framing dimensions.

### MINIMUM HORIZONTAL FRAMING DIMENSIONS

|             | VENT PIPE CENTER (A) | FRAMED OPENING TOP (B)               |
|-------------|----------------------|--------------------------------------|
| RIDGID PIPE | 33-3/8" (848mm)      | Per vent manufacturer's requirements |
| FLEX PIPE   | 36-7/8" (973mm)      | Per vent manufacturer's requirements |

## VERTICAL TERMINATIONS

Follow vent pipe manufacturer's installation instructions for vertical terminations. A minimum of 1" (25mm) clearance on all sides of vertical vent pipe must be maintained.

### NOTE

The included Horizontal Vent Heat Shield is not used for vertical configurations.

### CAUTION

Cold air transfer area. The surrounding fireplace chase must comply with all clearances as outlined in this manual and be constructed in compliance with local building codes. Outside walls should be insulated to prevent cold air from entering.

### CAUTION

Due to high temperatures, this fireplace should be located out of traffic areas and away from furniture and draperies.

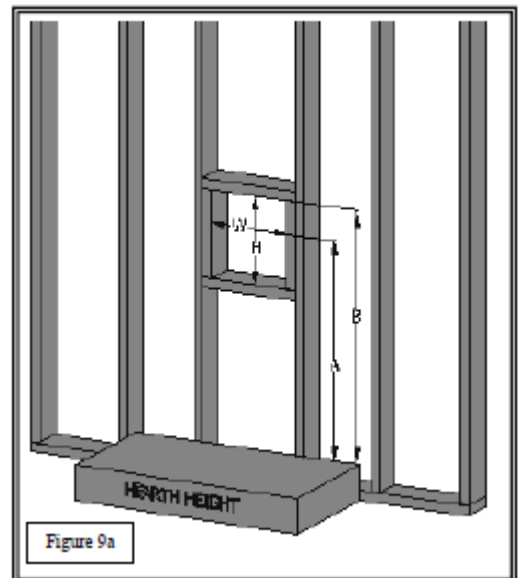

# TYPICAL INSTALLATION OPTIONS

## IMPORTANT

The horizontal heat shield included with this fireplace must be installed when incorporating minimum horizontal venting. This applies to Nat. and LP minimum horizontal venting configurations.

Horizontal vent heat shield not shown in illustrations below for clarity purposes only.

## TYPICAL HORIZONTAL INSTALLATION

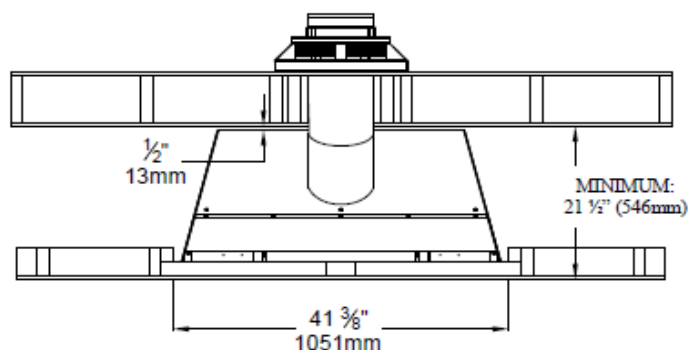

Figure 10a

## TYPICAL CORNER INSTALLATION

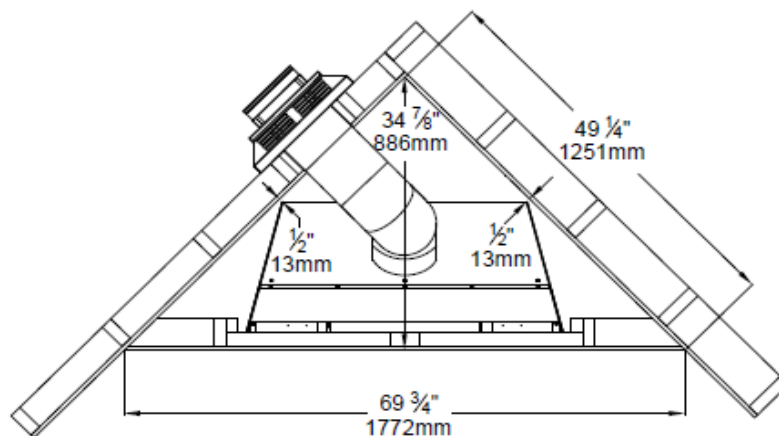

Figure 10b

## TYPICAL VERTICAL INSTALLATION

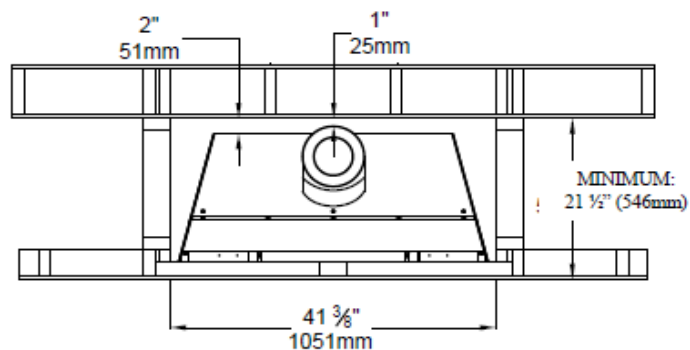

Figure 10c

## MANTEL REQUIREMENTS

### WARNING

TOP STAND-OFF BRACKETS MUST BE ASSEMBLED AND ATTACHED TO FIREPLACE. DO NOT REMOVE. STAND-OFF BRACKETS ARE NOT LOAD BEARING.

### NON-COMBUSTIBLE ZONE:

**Rigid pipe:** 1" (25mm) above elbow for entire width and depth (behind header) of fireplace.

**Flexible venting:** 1" (25mm) above elbow for entire width and depth (behind header) of fireplace.

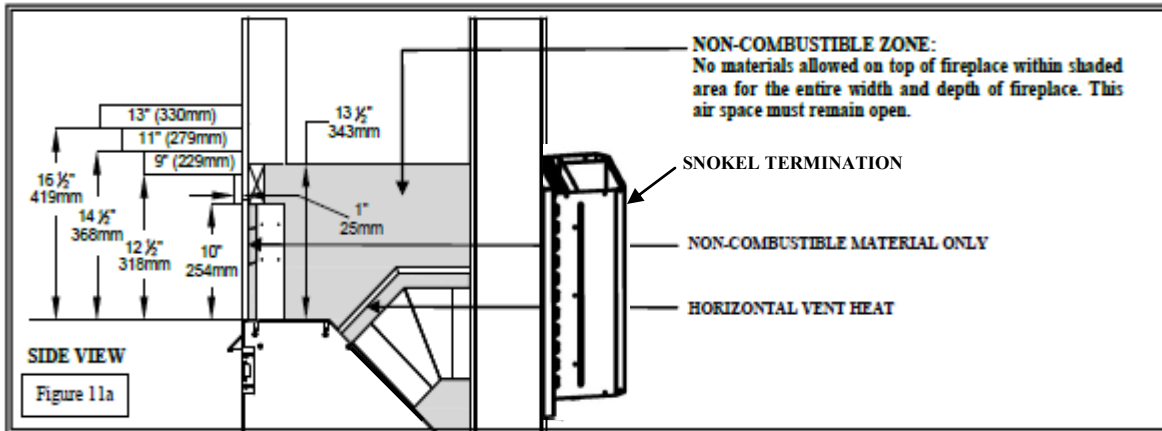

## GLASS FRAME ASSEMBLY

### CAUTION

TO PREVENT GLASS FRAME ASSEMBLY FROM FALLING FROM FIREPLACE AND BECOMING DAMAGED, FOLLOW THESE INSTRUCTIONS EXACTLY WHEN REMOVING AND INSTALLING GLASS FRAME ASSEMBLY.

### REMOVE GLASS FRAME ASSEMBLY

1. Locate spring-loaded handles securing glass frame assembly at top & bottom of firebox.
2. Pull bottom handles out and down to release glass frame assembly bottom.
3. Pull top handles out and up to release glass frame assembly top.
4. Remove glass frame assembly from fireplace.

### INSTALL GLASS FRAME ASSEMBLY

1. Making sure wide lip of glass frame assembly is at bottom and narrow lip at top, place assembly onto fireplace front.
2. Pull top handles out and down to secure glass frame assembly top.
3. Pull bottom handles out and up to secure glass frame assembly bottom.

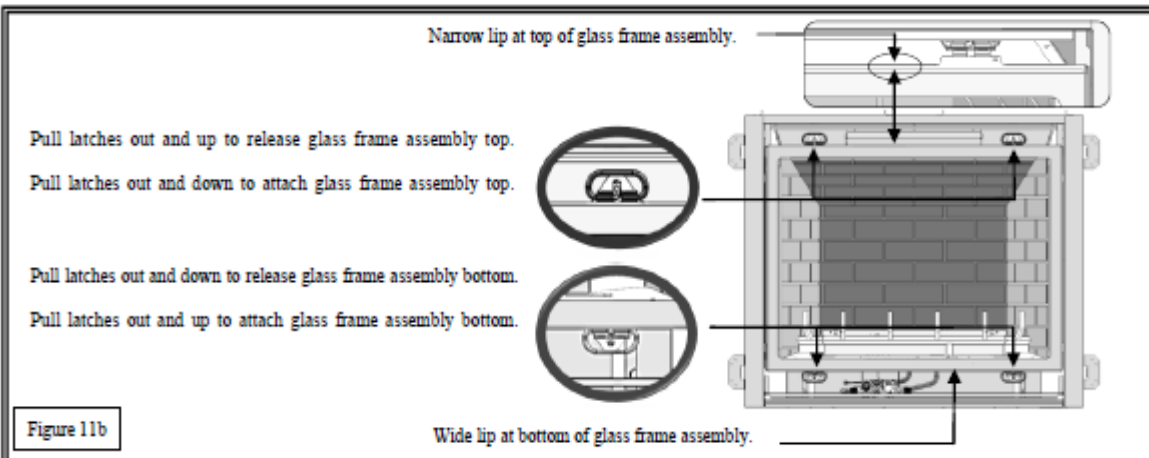



# GAS LINE CONNECTION

## GAS CONVERSION

This fireplace is manufactured for use with Natural Gas. Follow instructions included with conversion kit if converting to LP gas. (Sold separately).

### CAUTION

Installation of the gas line must only be done by a qualified person in accordance with local building codes, if any. If not, follow ANSI Z223.1.

Commonwealth of Massachusetts: Installation must be done by a licensed plumber or gas fitter.

### NOTE

A listed (and Commonwealth of Massachusetts approved) 1/2" (13mm) T-handle manual shut-off valve and flexible gas connector (included) are connected to the 1/2" (13mm) control valve inlet. If substituting for these components, please consult local codes for compliance.

This fireplace is equipped with a 3/8" (10mm) x 18" (457mm) long flexible gas connector and manual shut-off valve. The gas line should be run to the point of connection where the shut-off valve and flexible gas line will connect.

The appliance and its individual shutoff valve must be disconnected from the gas supply piping system during any pressure testing of that system at pressures in excess of 1/2 psi (3.5 kPa).

The appliance must be isolated from the gas supply piping system by closing its individual manual shut-off valve during any pressure testing of the gas line at test pressures equal to or less than 1/2 psi (3.5 kPa).

For high altitude installations, consult the local gas distributor or the authority having jurisdiction for proper rating methods.

### IMPORTANT

The efficiency rating of this appliance is a product of thermal efficiency rating determined under continuous operating conditions and was determined independently of any installed system.

|                            | <u>NATURAL GAS</u> | <u>LP GAS</u>     |
|----------------------------|--------------------|-------------------|
| MINIMUM INLET GAS PRESSURE | 5" WC (1.25 kPa)   | 11" WC (2.74 kPa) |
| MAXIMUM INLET GAS PRESSURE | 7" WC (1.74 kPa)   | 13" WC (3.24 kPa) |
| MANIFOLD PRESSURE (HI)     | 3.8" WC (.95 kPa)  | 10" WC (2.49 kPa) |
| MANIFOLD PRESSURE (LO)     | 1.1" WC (.27 kPa)  | 2.9 (.72 kPa)     |
| ORIFICE SIZE               | #56 & #33          | #62 & #49         |
| INPUT BTU/hr. (kW)         | 39,500 (11.58 kW)  | 39,500 (11.58 kW) |
| MINIMUM INPUT BTU/hr. (kW) | 19,500 (5.72 kW)   | 19,500 (5.72 kW)  |

## LIGHT KIT COMPONENT INSTALLATION

### CAUTION

Disconnect all electrical power from fireplace before performing this task.

### NOTE

To avoid damage and prolong the life of halogen bulbs, never touch with bare hands. Always use a soft cloth when handling.

1. Install halogen bulbs (included in components packet) into lamp bases.
2. Place amber light filters into light cylinders.

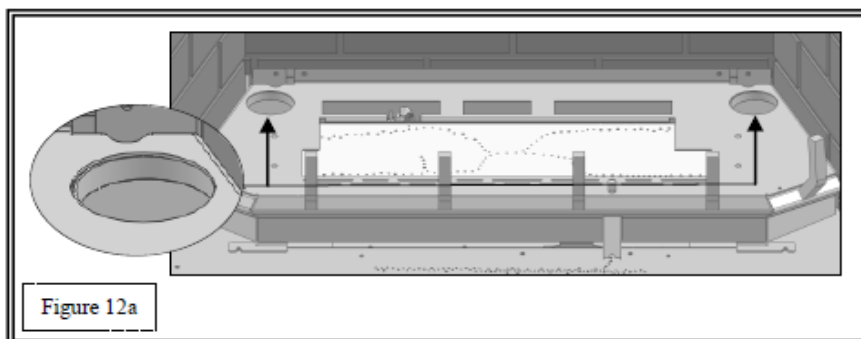

# VENTING

## WARNING

Consult the local and international codes to assure adequate combustion and ventilation air is available.  
Flame height and appearance will vary depending upon venting configuration and type of fuel used.  
Venting requirements apply to both Natural and LP gas.

Refer to the vent manufacturer's installation manual for complete installation instructions.  
Installation must conform with the venting requirements and restrictions as outlined in this manual.  
Provide a means for visually checking vent connection to fireplace after fireplace is installed.

## APPROVED VENTING

Simpson Dura-Vent DV-GS 5" x 8" and 4" x 6-5/8" with reducer (horizontal and vertical terminations).  
Metal Fab Direct Chimney Systems 5" x 8" (horizontal and vertical terminations).  
ICC Direct Chimney Systems 5" x 8" (horizontal and vertical terminations).  
Selkirk-Metalbestos Chimney Systems 5" x 8" and 4" x 6-5/8" with reducer (horizontal and vertical terminations).  
BDM 5" x 8" Chimney Systems, flex and rigid (horizontal and vertical terminations).  
Security 5" x 8" Chimney Systems (horizontal and vertical terminations).  
Ameri-Vent 5" x 8" Chimney Systems (horizontal and vertical terminations).

## HORIZONTAL TERMINATIONS

### HORIZONTAL VENT SYSTEM CLEARANCES

|                      | TOP             | BOTTOM        | SIDES         |
|----------------------|-----------------|---------------|---------------|
| ALL APPROVED VENTING | 2 INCHES (25mm) | 1 INCH (25mm) | 1 INCH (25mm) |

## HORIZONTAL MIN. / MAX.

MINIMUM: 45° elbow + 6" - 24" Pipe (152mm - 609mm) + snorkel termination cap.

MAXIMUM: 45° elbow + 1ft. Pipe (305mm) + 90° elbow + 3 ft. pipe (914mm) + snorkel termination cap.

## HORIZONTAL MIN. / MAX. (with reducer)

NAT GAS MINIMUM: 2ft. (610mm) vertical + reducer + 90° elbow + 6" (152mm) horizontal + termination cap.  
NAT GAS MAXIMUM: 2ft. (610mm) vertical + reducer + 90° elbow + 12ft. (3.66m) + termination cap.  
LP GAS MINIMUM: 2ft. (610mm) vertical + reducer + 90° elbow + 6" (152mm) + termination cap.  
LP GAS MAXIMUM: 2ft. (610mm) vertical + reducer + 90° elbow + 2ft. (610mm) + termination cap.  
LP GAS MAXIMUM: 3ft. (914mm) vertical + reducer + 90° elbow + 12ft. (3.66m) + termination cap.

## IMPORTANT

Wall pass-thru required for all horizontal runs. Refer to vent manufacturer to determine which pass-thru will work best for your application and wall thickness.

The horizontal vent shield must be installed when using a 45° elbow to horizontally position the vent system.  
Exception: corner installations.

## ELBOWS

The following statement applies to horizontal, vertical, or a combination of horizontal / vertical elbows:  
For each additional 90° elbow used after the first elbow, 3ft. (914mm) must be subtracted from the maximum allowed venting. For each 45° elbow used, 1-1/2ft. (457mm) must be subtracted from the maximum venting allowed.

## NOTE

(2) 45° degree elbows may be used in place of (1) 90° elbow.

# VENTING

## NOTE

Horizontal sections require 1/4" (6mm) rise for every 12" (305mm) of travel.

## CAUTION

This gas appliance must not be connected to or joined with any other chimney flue serving another appliance.

## HORIZONTAL TERMINATIONS

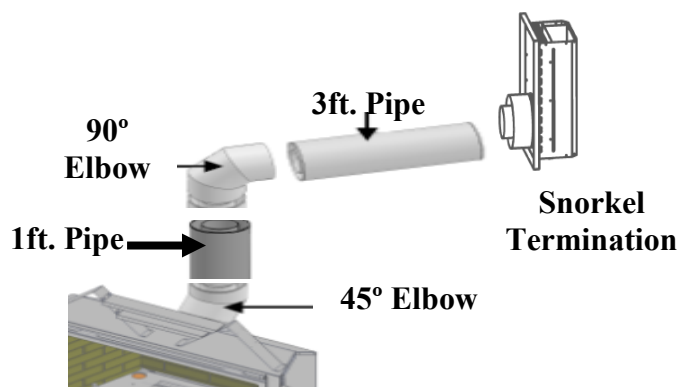
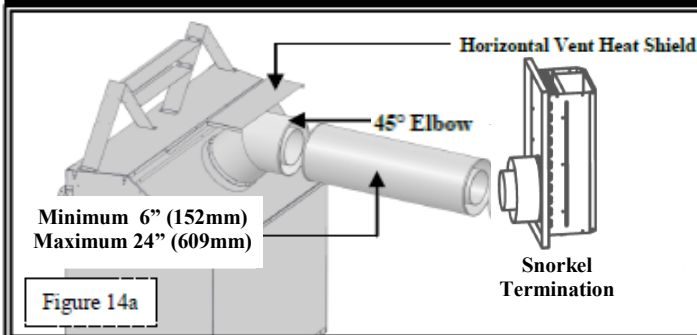

## VERTICAL TERMINATIONS

### VERTICAL VENT SYSTEM CLEARANCES

|                               | SIDES         |
|-------------------------------|---------------|
| ALL APPROVED VERTICAL VENTING | 1 inch (25mm) |

### VERTICAL MIN. / MAX.

MINIMUM: 45° elbow + 3ft. (915mm) + termination cap.

MAXIMUM: 45° elbow + 50ft. (15.2m) + termination cap.

MAXIMUM (if using reducer):

45° elbow + 2ft. (610mm) + reducer + 48ft. (14.63m) + term. cap.

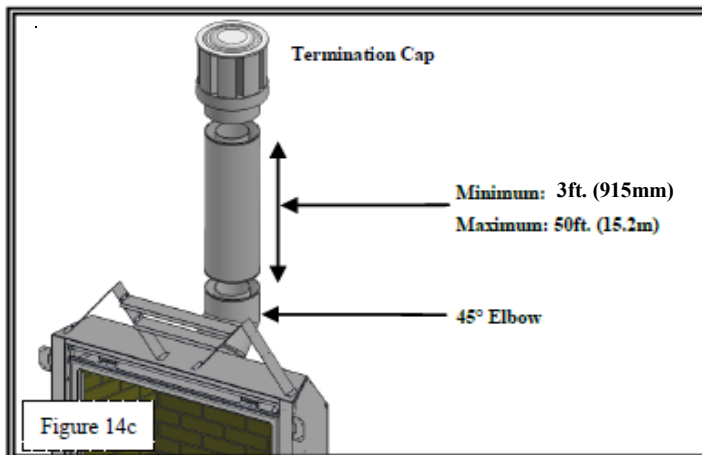

## RESTRICTOR SETTING

This fireplace is shipped with the restrictor set in open position. Follow chart for recommended settings based on venting configuration.

It is important to remember each installation is unique and affected by various factors including venting configuration, altitude and climate. Therefore, after fireplace installation is complete, restrictor setting adjustment may be necessary. Page 32 has information on restrictor recommendations depending on burner flame appearance after installation is completed.

Restrictor setting adjustment handle is located at top front of firebox. Remove glass frame assembly to access. Loosen screw, adjust setting, tighten screw and reinstall glass frame assembly.

### RECOMMENDED RESTRICTOR SETTINGS

| VENTING                       | RESTRICTOR POSITION                 |
|-------------------------------|-------------------------------------|
| Min. - 20ft. (6.1m)           | FULL OPEN (handle pulled forward)   |
| 20 ft. (6.1m) - 35ft. (10.7m) | PARTIAL OPEN (handle set to center) |
| 35ft. (10.7m) - 50ft. (15.2m) | CLOSED (handle pushed back)         |

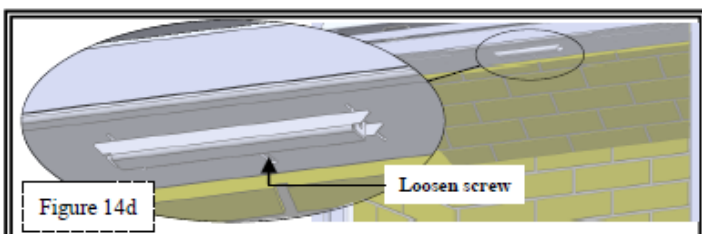

# VENTING

## HORIZONTAL & VERTICAL COMBINATION TERMINATIONS

MAXIMUM: 18ft. (5.49m) horizontal + 18ft. (5.49m) vertical + cap. [36ft. (10.98m) total].

MAXIMUM (with reducer): 45° elbow + 2ft. (610mm) + reducer + 16ft. (4.88m) hor. /vert + 18ft. (5.49m) hor / vert + term. cap.

### ATTENTION

IF INSTALLING WITH RIGID-TO-FLEX PIPE SYSTEMS:

More than a 30 degree bend constitutes a 45 degree elbow.

More than a 45 degree bend constitutes a 90 degree elbow.

More than a 90 degree bend is not permissible.

### IMPORTANT

Wall pass-thru required for all horizontal runs. Refer to vent manufacturer to determine which pass-thru will work best for your application and wall thickness.

The horizontal vent heat shield must be installed when using a 45-degree elbow to horizontally position the vent system. Exception: corner installations.

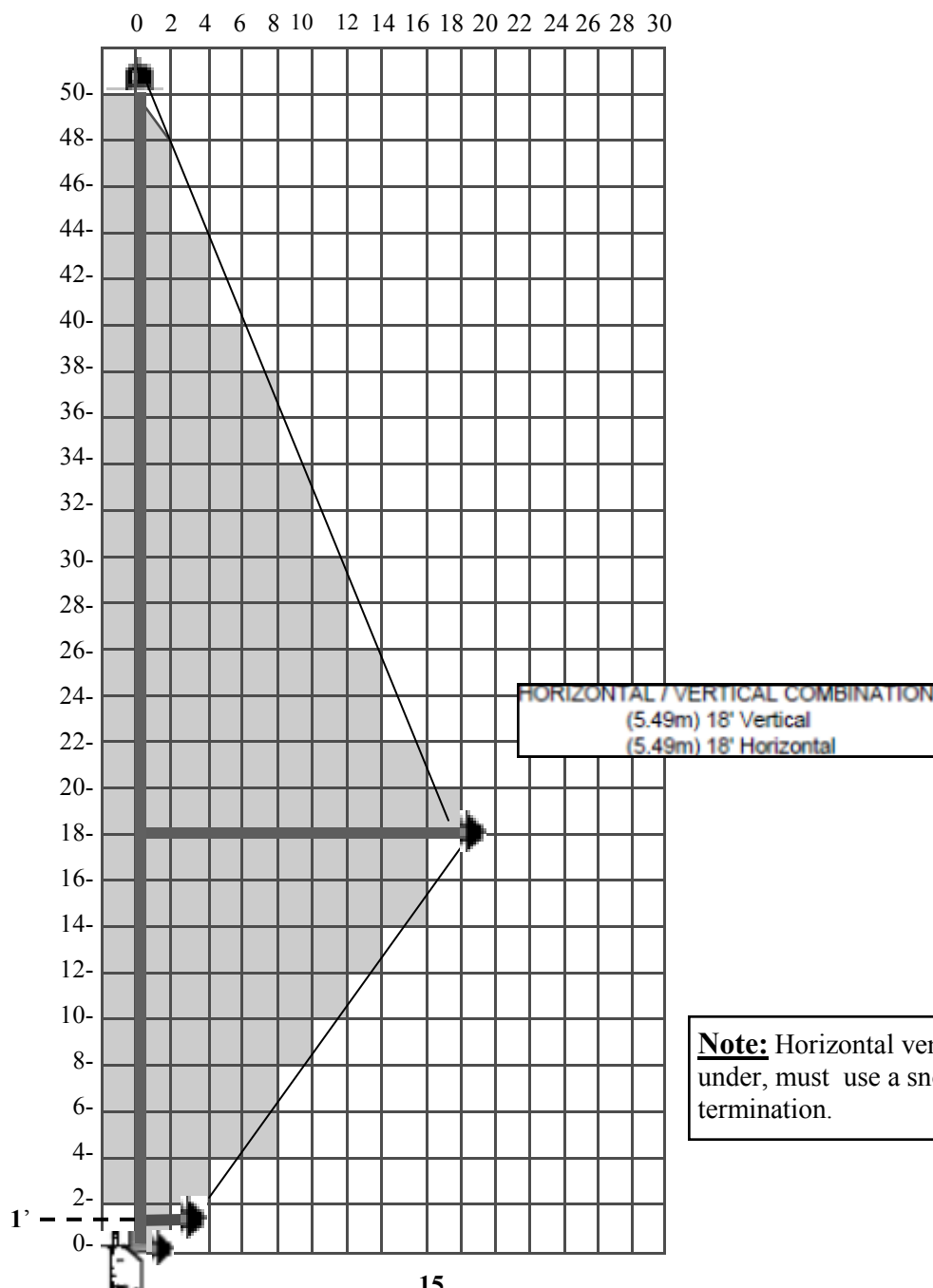

**Note:** Horizontal venting 3ft and under, must use a snorkel style termination.

# TERMINATION VENT CAP LOCATION

**This gas appliance must not be connected to a chimney serving any other appliance.**

1. Terminations against vinyl siding must use a vinyl siding protector. Follow instructions included.
2. **DO NOT RECESS TERMINATION KIT INTO OUTSIDE BUILDING MATERIALS** - i.e.: brick, stone, siding, etc. If necessary, extend framing so that termination kit will be exposed once building materials are installed.
3. Vent termination must not be located where it will become plugged by snow or other material. The flow of combustion and ventilation air must be not obstructed.

## LOCATION CLEARANCES

- A. Above grade, veranda, porch, deck, balcony - 12" (305mm).
- B. Operable window or door - CANADA: 12" (305mm). US: 9" (229mm).
- C. Permanently closed window\* - 12" (305mm) (recommended to prevent condensation on window).
- D. Ventilated soffit\* - 24" (610mm).
- E. Unventilated soffit\* - 12" (305mm).
- F. Outside corner\* - 3" (76mm).
- G. Inside corner\* - 10" (254mm).
- H. Meter / Regulator: CANADA: Not to be installed above a gas meter/regulator assembly within 3ft. (914mm) horizontally from the centerline of the regulator within a height of 15ft. (4.57m). US\*.
- I. Gas Service regulator vent outlet : CANADA: 3ft. (914mm). US\*.
- J. Non-mechanical air supply inlet to building or the combustion air inlet to any other appliance. CANADA: 12" (305mm). US: 9" (229mm).
- K. Mechanical air supply inlet. CANADA: 6ft. (1.83m) US: 3ft. (914mm) above if within 10ft. (3.05m) horizontally. Massachusetts installations: 10ft. (3.05m).
- L. Above paved side-walk or paved driveway located on public property - 7ft. (2.13m). US\*

### NOTE

A vent cannot be located directly above a side-walk or paved driveway that is located between two single family dwellings and serves both dwellings.

- M. Under veranda, porch, deck, or balcony (must be fully opened on a minimum of 2 sides) - 12" (305mm).
- N. Between two horizontal terminations - 12" (305mm).
- O. Between two vertical terminations - 12" (305mm). Terminations may be same height.
- P. Above furnace exhaust or inlet - 12" (305mm).

\*Clearance must be in accordance with local installation codes & the requirements of the gas supplier.

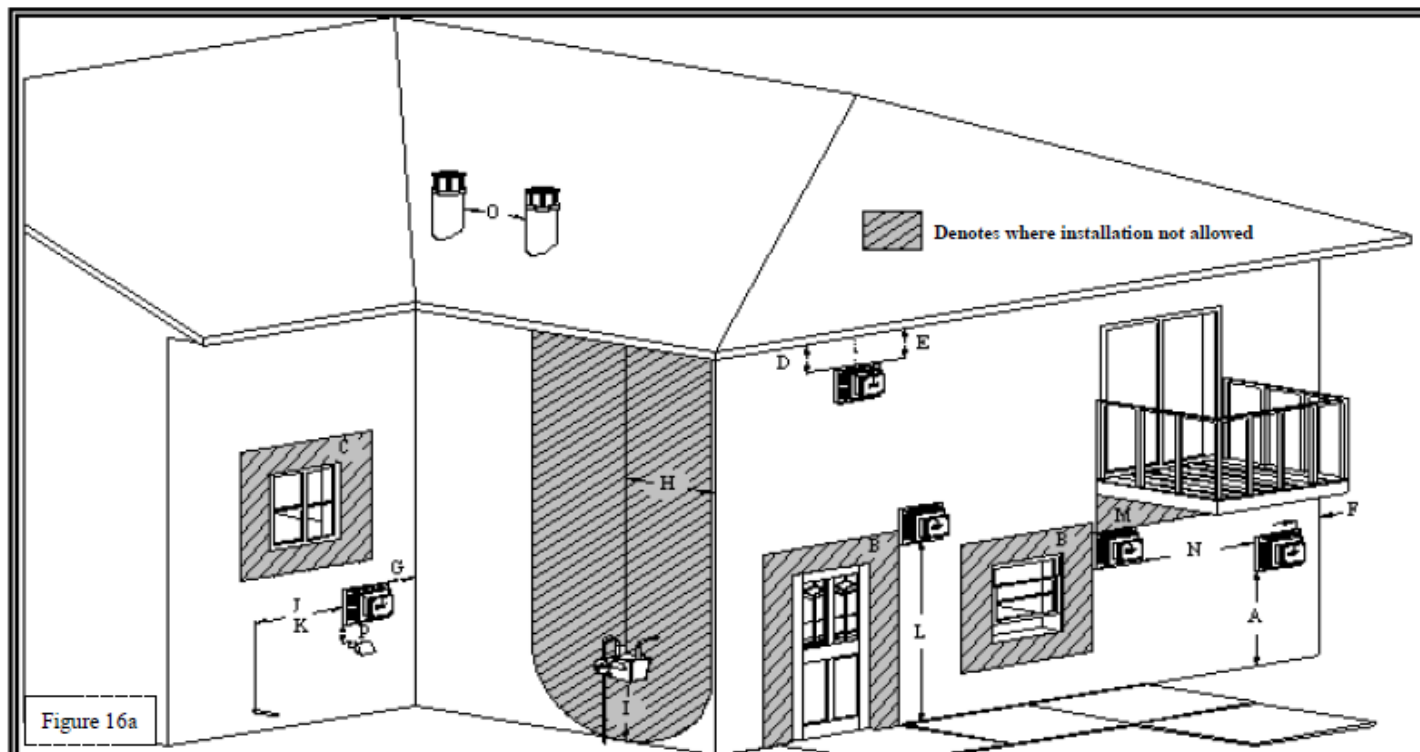

Figure 16a



# VENTING (Vertical Cap Requirements)

## VENT TERMINATION CLEARANCES

| Roof Pitch          | H (Min.) Ft. | H (Min.) m |
|---------------------|--------------|------------|
| Flat to 6/12        | 1.0          | 0.30       |
| Over 6/12 to 7/12   | 1.25         | 0.38       |
| Over 7/12 to 8/12   | 1.5          | 0.46       |
| Over 8/12 to 9/12   | 2.0          | 0.61       |
| Over 9/12 to 10/12  | 2.5          | 0.76       |
| Over 10/12 to 11/12 | 3.25         | 0.99       |
| Over 11/12 to 12/12 | 4.0          | 1.22       |
| Over 12/12 to 14/12 | 5.0          | 1.52       |
| Over 14/12 to 16/12 | 6.0          | 1.83       |
| Over 16/12 to 18/12 | 7.0          | 2.13       |
| Over 18/12 to 20/12 | 7.5          | 2.27       |
| Over 20/12 to 21/12 | 8.0          | 2.44       |

### CAUTION

This appliance must not be connected to or joined with any chimney flue serving any other appliance.

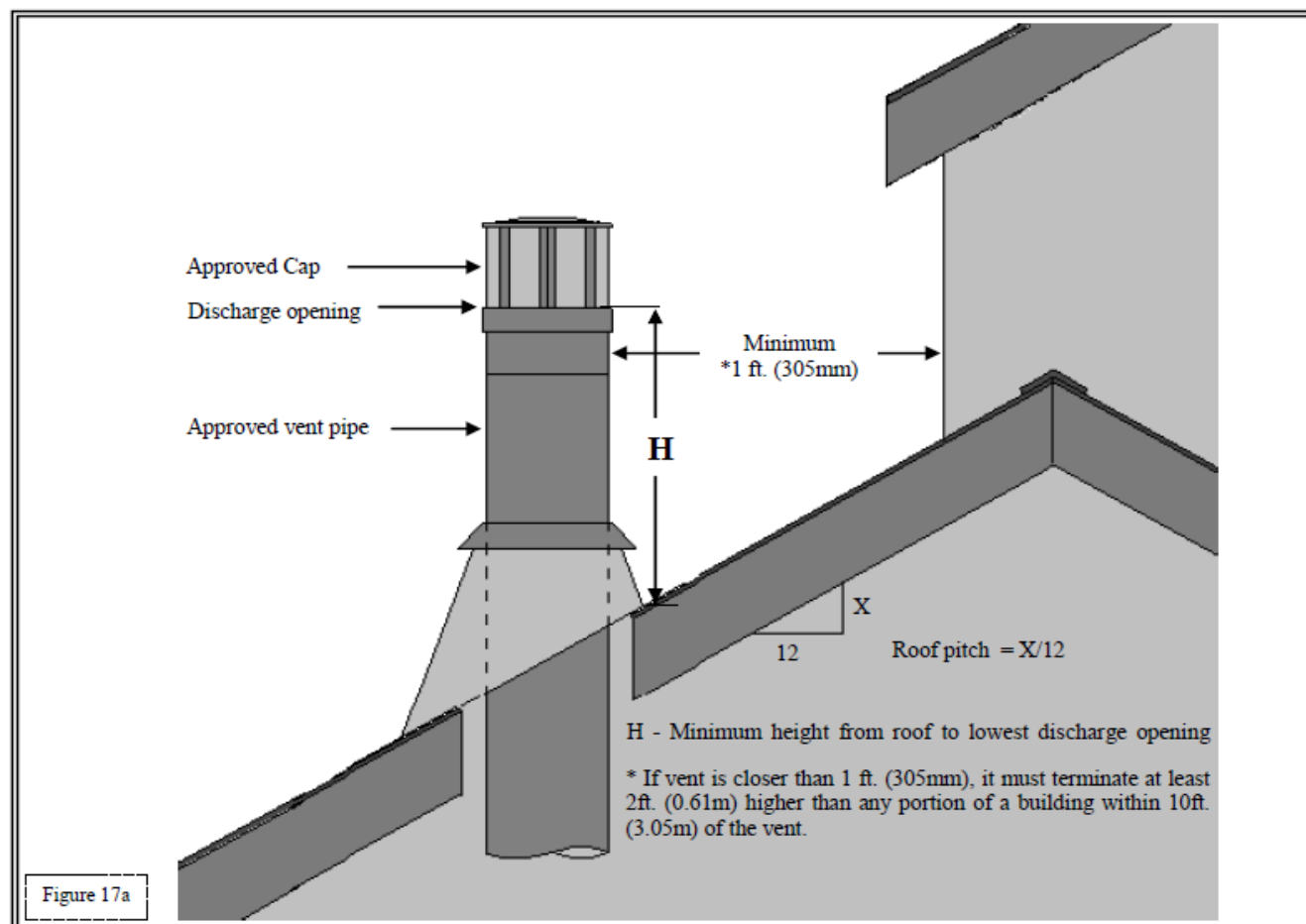

# UF0100 LOG SET INSTALLATION

**ATTENTION** If converting to LP (propane) gas do so now before installing log set. Follow instructions included with kit. (Sold separately).

**NOTE** Log numbers are located on the bottom of each log. Refer to following instructions and illustrations for proper placement.

**CAUTION** Do not place logs directly over burner port holes. Improper log placement may affect flame appearance and cause excessive soot to build up on logs and glass.

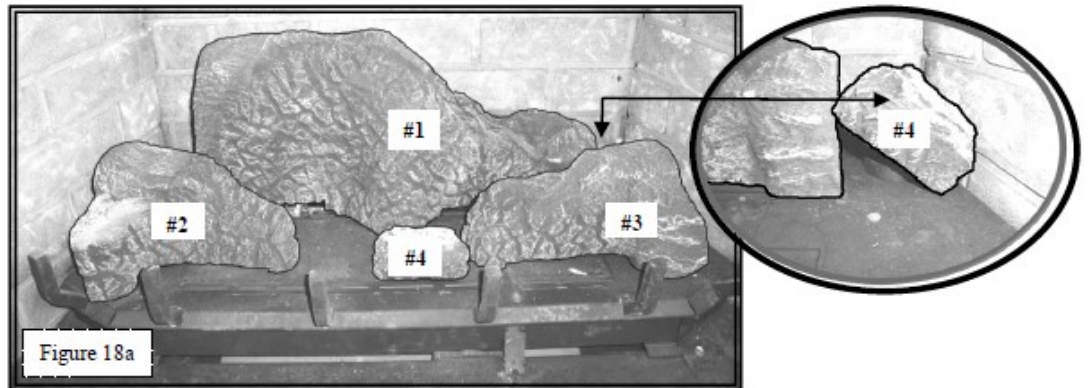

Align holes in bottom of logs #1, #2 & #3 with mounting pins on burner cover, setting down into position. Position #4 logs (2) as shown above. Do not allow logs to block burner ports.

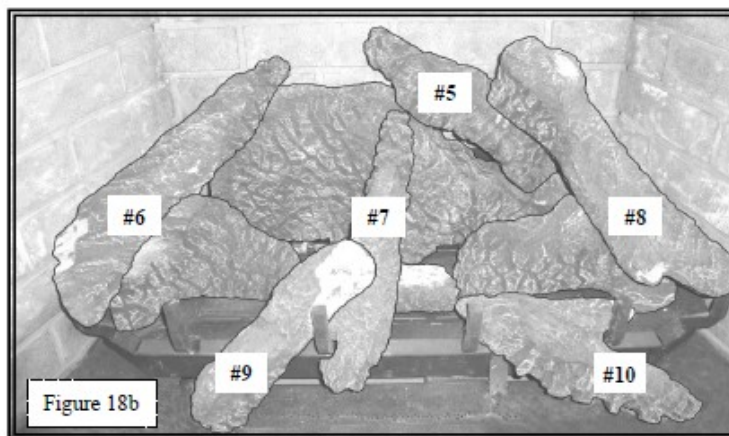

Install #5 - #10 logs as shown above, aligning with notches in base logs, and in the case of log #7, aligning notch in log with burner grate.

Install #11 - #12 logs as shown below, aligning with notches in lower logs.

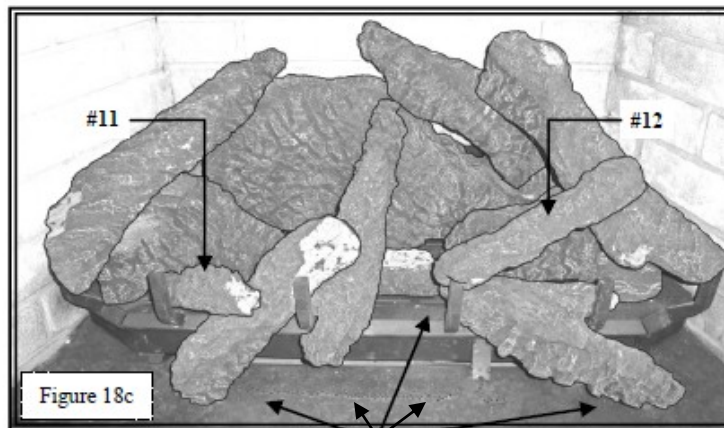

Black Embers should be placed in open areas and as not to completely block burner ports.

# BURNER REMOVAL

## CAUTION

If burner and/or pilot have been burning, use appropriate protection to avoid burns or damage to personal property before removing any components.

## WARNING

DO NOT OPERATE THIS FIREPLACE WITHOUT SEALING GASKET (LOCATED UNDER CONTROL BOARD) IN PLACE. IF GASKETING IS DAMAGED, IT MUST BE REPLACED.

1. Use remote to turn fireplace off.
2. Shut off gas supply at manual shut-off valve. Disconnect gas line flex tube from the manual shut-off valve.
3. Unplug all components from electrical outlet, disconnect all wiring harnesses attached to gas valve.
4. Disconnect light kit communication link (black and white leads) from module communication link (black and white leads).
5. Remove upper hood, upper louver, glass assembly, and logs.
6. Remove back burner; secured with screws, (2) at front, (2) at back.
7. Remove light kit cylinders, amber light filters, and halogen bulbs. Remove screws securing light stands, lay light stands on control board.
8. Remove side refractory panels.
9. Loosen front orifice bracket screws, push orifice backwards far enough to release from venturi.
10. Remove front burner, secured with screws, (2) at front, (2) at back.
11. Remove (8) screws securing control board. Lift board up and out of firebox.

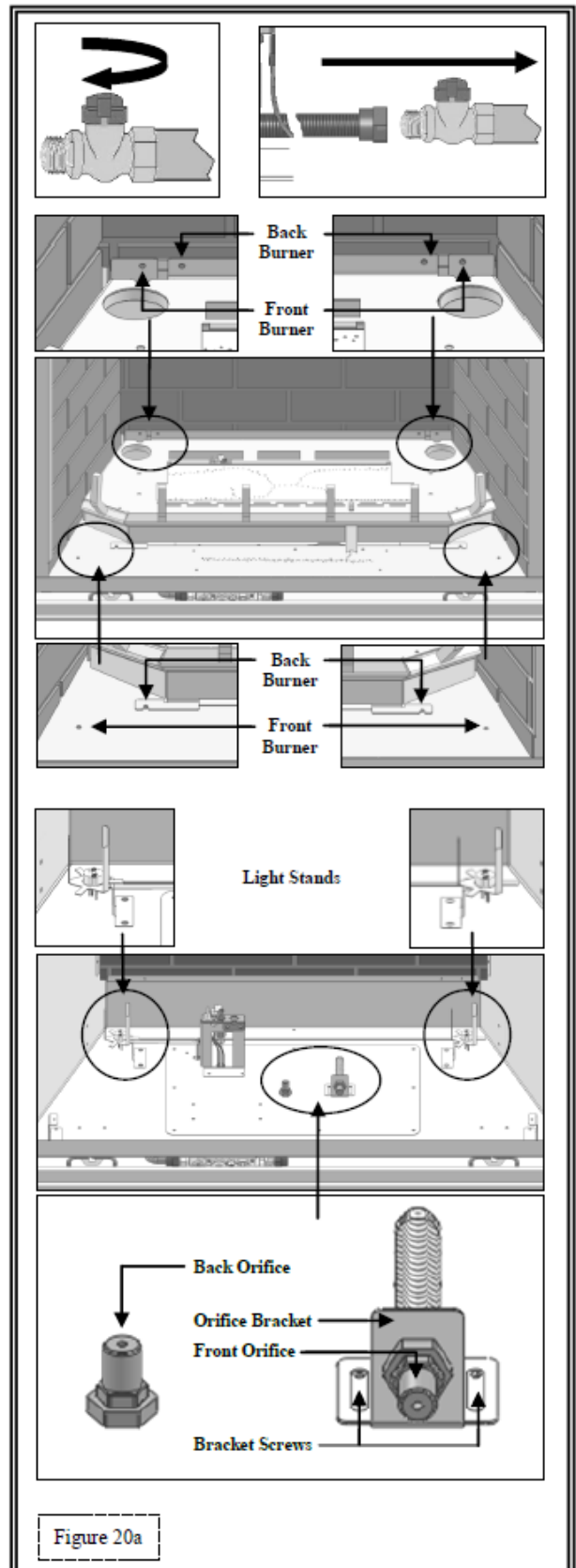

# BUNRER INSTALLATION

## WARNING

**DO NOT OPERATE THIS FIREPLACE WITHOUT SEALING GASKET (LOCATED UNDER CONTROL BOARD) IN PLACE. IF GASKETING IS DAMAGED, IT MUST BE REPLACED.**

1. Place burner in firebox, aligning holes in burner to holes in firebox bottom. Make sure gasket is in place on firebox bottom. Secure with screws previously removed.
2. Reinstall front burner. Align front burner orifice with front venturi, pull orifice bracket forward until orifice is seated inside venturi. Tighten orifice bracket screws. Figure 20a. Secure burner with (4) screws previously removed.
3. Reinstall side refractory panels.
4. Reinstall light kit stands (secure with screws previously removed), halogen bulbs, cylinders and amber light filters.
5. Reinstall back burner assembly, making sure venturi is properly positioned over back burner orifice. Figure 20a. Secure with 4 screws previously removed.
6. Reinstall log set.
7. Reconnect gas line to manual shutoff valve.
8. Reconnect all wiring harnesses to gas valve. Plug all components into electrical outlet.
9. Reconnect light kit communication link (black and white leads) to module communication link (black and white). (black to black, white to white).
10. Reinstall glass frame assembly, upper hood and upper louver.
11. Turn gas on.
12. Verify proper log placement, operation of fireplace, and any electrical components.

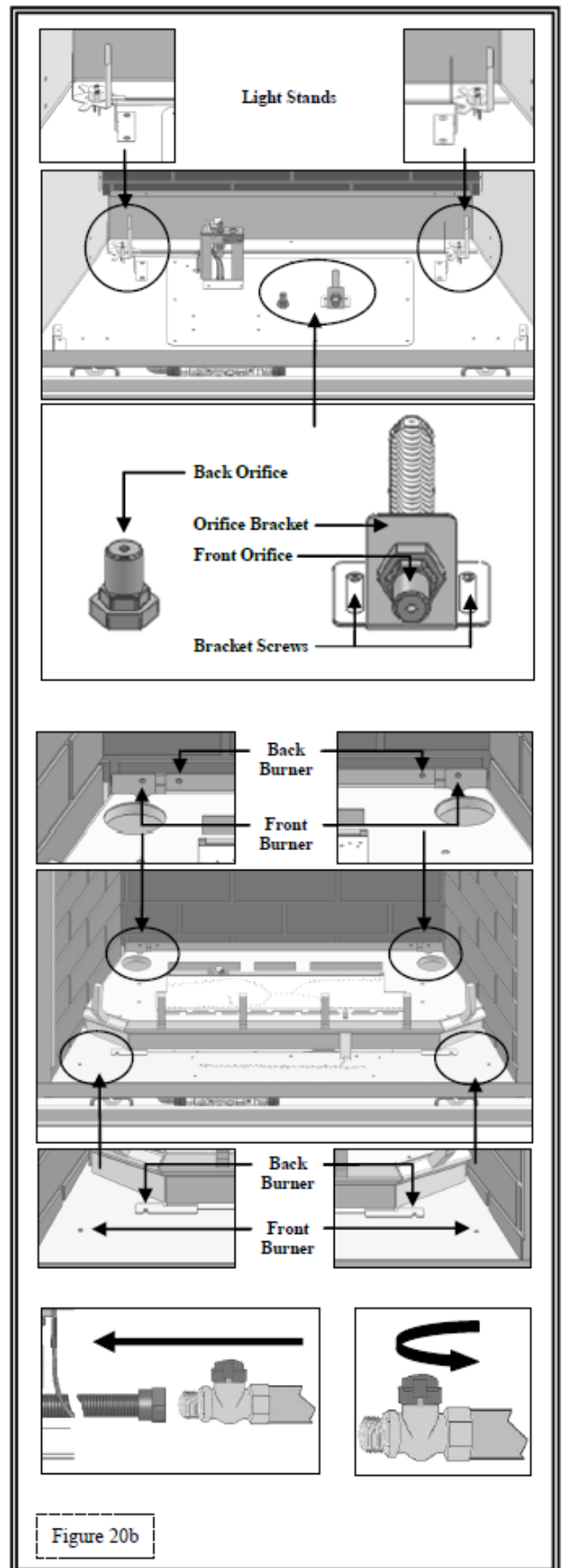
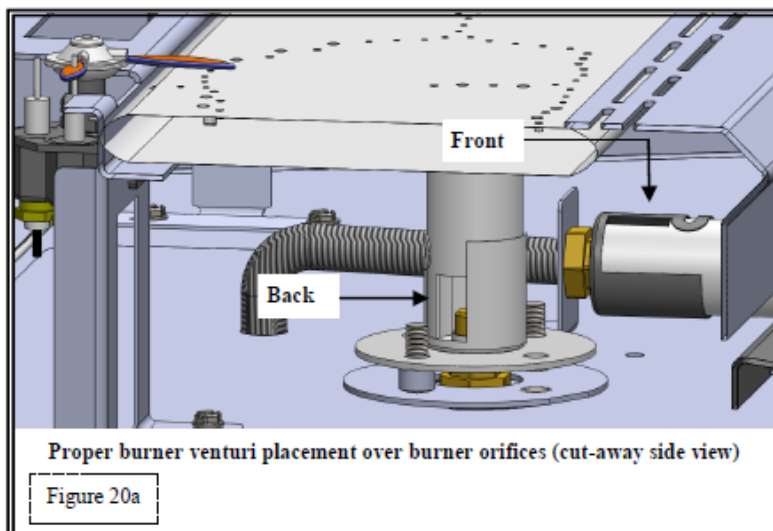



# GRILL SET

## INSTALLATION

1. Align hooks in upper louver to slots located in fireplace face. Set down into position.
2. Insert upper hood flange into clips located at top of upper air passage, keeping in mind this is a fairly tight fit.
3. Partially thread (2) screws (included in components packet) into nuts at each end of lower grill. Secure to fireplace by threading screws into corresponding holes in inside flange of lower grill opening. The lower grill can now be opened and closed to access gas valve and controls.

## REMOVAL

1. Use both hands to pull hood out of upper air passage clips.
2. Lift upper louver up and out of slots.
3. Remove screws securing lower grill at each end to remove from fireplace.

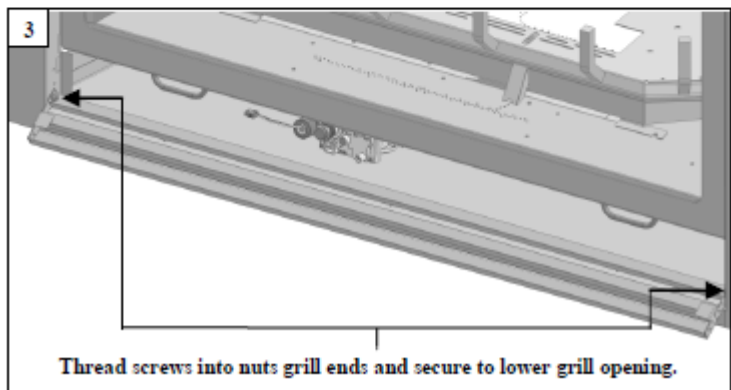
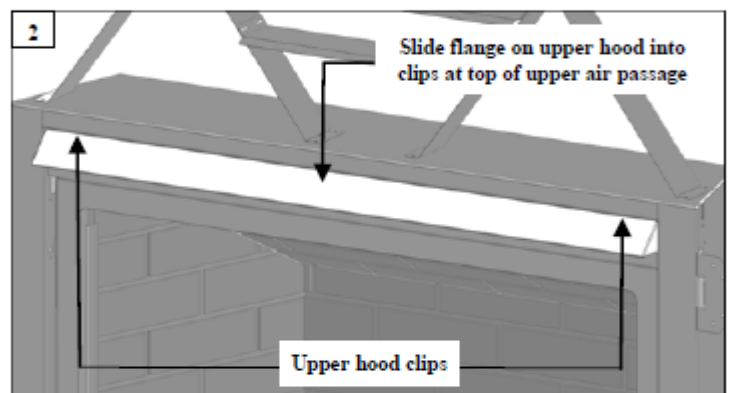
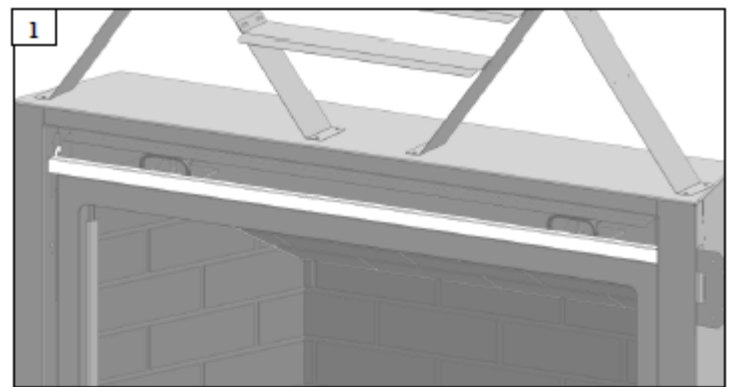

Figure 21a



# WIRING SCHEMATICS

## IMPORTANT

THIS SYSTEM REQUIRES ELECTRICITY (120V) AND / OR BATTERIES TO OPERATE.

USING BATTERY BACK UP WILL OPERATE BURNER ONLY. FAN AND LIGHT COMPONENTS WILL NOT FUNCTION ON BATTERY BACK-UP POWER.

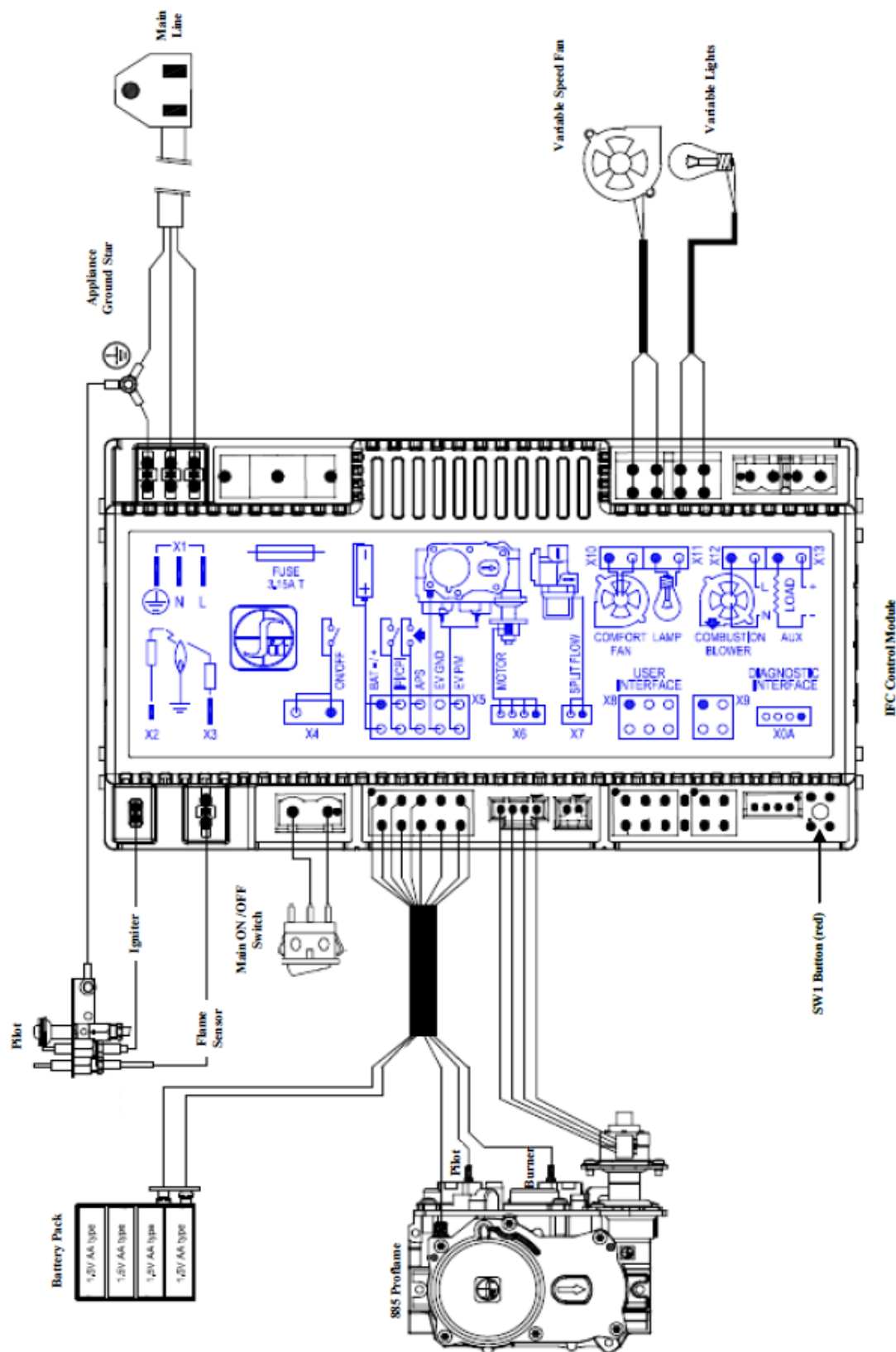
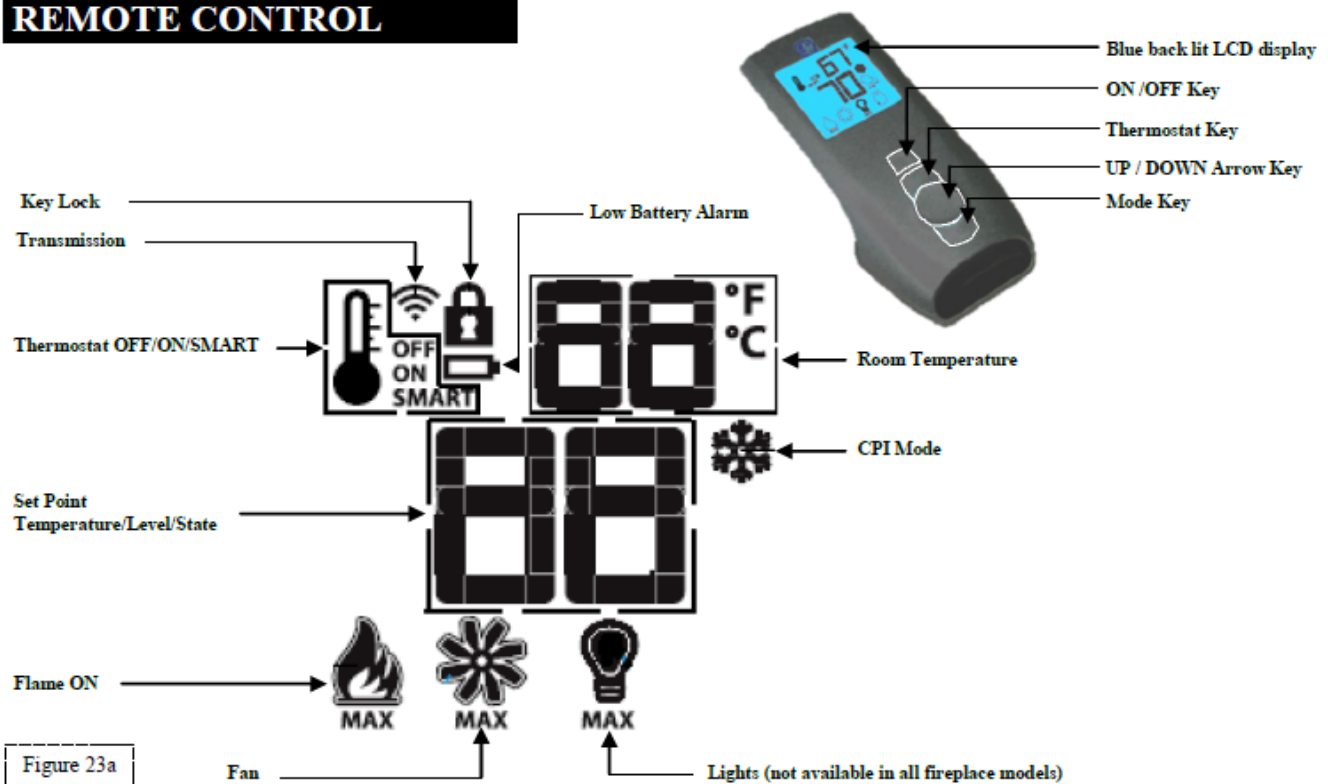

Figure 22a

# CONTROL SYSTEM COMPONENTS

## REMOTE CONTROL



## GAS VALVE

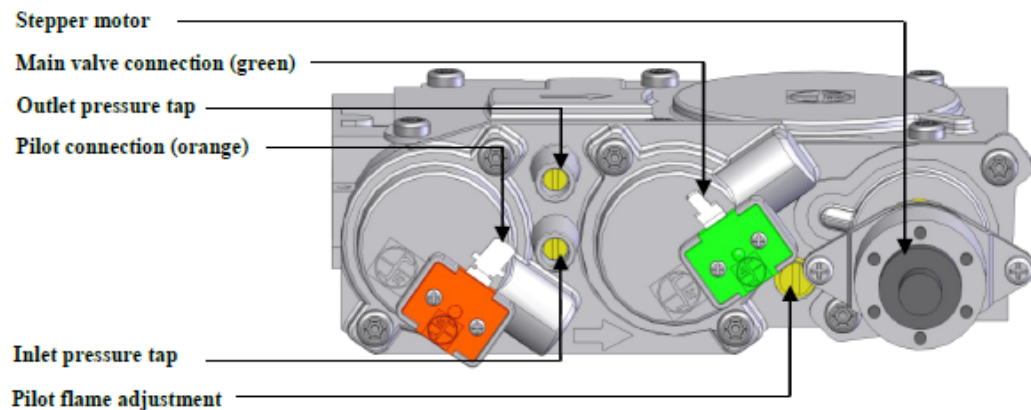

## PILOT ASSEMBLY



# SYSTEM OPERATION

## INITIALIZING THE SYSTEM FOR THE FIRST TIME

1. Set ON/OFF rocker switch to OFF position.
2. Install 4 AA batteries (included in components packet) into battery backup holder.
3. Connect IFC Control Module to AC power supply.
4. Install 3 AAA batteries (included in components packet) into remote control battery bay (located on base of remote control).

**NOTE:** Performing the next step will initiate Pilot Start-up in Manual Mode:

Pilot igniter will spark repeatedly.

Pilot will ignite if gas is supplied to the fireplace.

**Remove all packaging / combustible material from fireplace before proceeding.**

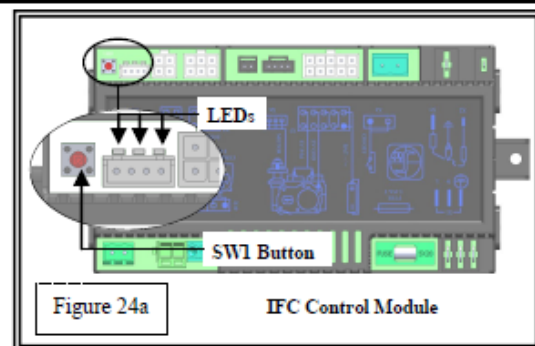

5. Press red SW1 button on IFC control module until module beeps three (3) times and/or an amber LED is illuminated indicating the IFC control module is ready to synchronize with the remote control.
6. Within ten (10) seconds push remote control ON/OFF button. The IFC control module will beep (4) times to indicate the remote control's command is accepted and set to the particular code of that remote control. Press remote control ON/OFF button again. The pilot will shut down indicating the remote has taken over. The system is now initialized.
7. Setting ON/OFF rocker switch to ON position will allow you to operate fireplace with remote control.

## TEMPERATURE DISPLAY

With the system in **OFF** position, press Thermostat Key and Mode Key at the same time to change from degrees F to C. Look at remote control LCD screen to verify that C or F is visible on right side of Room Temperature display.

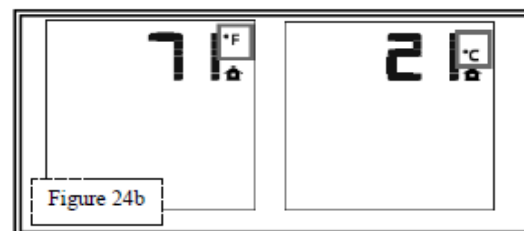

## TURN ON THE APPLIANCE

Press ON/OFF key on remote control. The display will show all active icons on the screen. A single 'beep' from IFC Control Module will Confirm reception of the command.

## TURN OFF THE APPLIANCE

Press ON/OFF key on remote control. The display will show only room temperature and icon on the screen. A single 'beep' from IFC control module will confirm reception of the command.

## MANUALLY CONTROL FLAME WITH REMOTE CONTROL

The remote control has six (6) flame levels. With system ON and flame level at maximum, press Down Arrow Key once to reduce flame height by one step until flame is turned off. The Up Arrow Key will increase flame height on step each time it is pressed. If Up Arrow Key is pressed while system is on but flame is off, the flame will come on in High position. A single 'beep' will confirm reception of the command. When SMART Thermostat is activated, manual flame height adjustment is disabled.

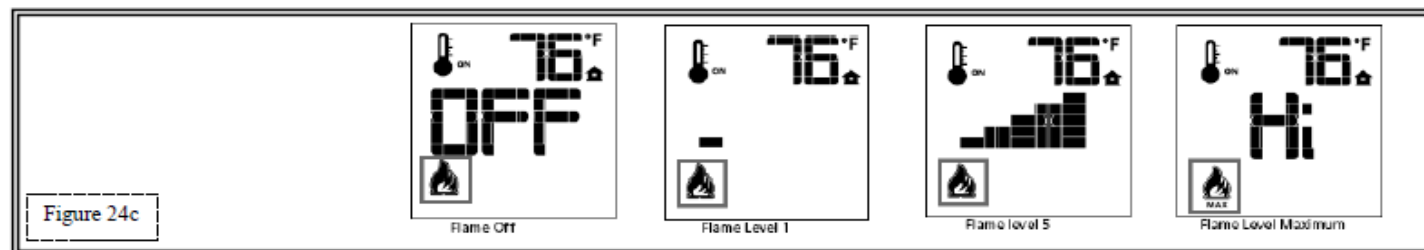

# SYSTEM OPERATION

## ROOM THERMOSTAT (Remote Control Operation)

The remote control can operate as a room thermostat. The thermostat can be set to desired temperature to control a rooms comfort level.

To activate this function, press the Thermostat Key. The LCD display will change to show the room thermostat is ON and set temperature is now displayed. To adjust set temperature, press Up or Down arrow keys until desired set temperature is display on LCD screen.

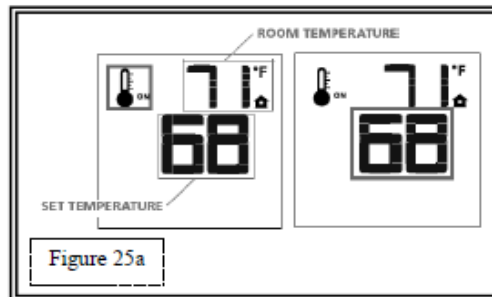

## SMART THERMOSTAT (Remote Control Operation)

The Smart Thermostat function adjusts flame height based on set temperature and actual room temperature. As room temperature gets closer to set point the Smart Function will automatically adjust flame down.

1. Press Thermostat key until word SMART appears on right side of temperature bulb graphic.
2. To adjust set temperature, press Up/Down arrow keys until desired set temperature is displayed on LCD screen.

When SMART Thermostat is activated, manual flame height adjustment is disabled.

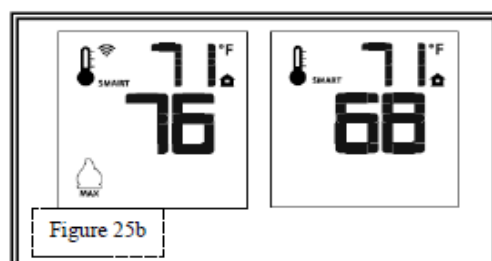

## FAN SPEED CONTROL

Fan speed can be adjusted through six (6) speeds. To activate this function use Mode Key to index to fan control icon. Use Up/Down Arrow Keys to turn on, off or adjust fan speed. A single 'beep' will confirm reception of the command.

**In Thermostat Mode:** Fan(s) have a five (5) minute delay time when fireplace is lit, allowing time for heat to build in fireplace before operating, and will continue operating for approximately twelve (12) minutes after fireplace has been turned off.

**In Manual Mode:** Fan (s) will operate at previous setting. There is no delay in start up or stop time.

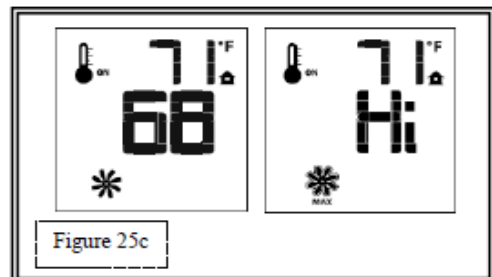

## ACCENT LIGHT KIT (not available in all fireplace models)

1. Use MODE key to guide you to LIGHT icon.
2. The light intensity can be adjusted through six (6) levels. Use UP/DOWN Arrow Keys to adjust intensity level. A single beep will confirm reception of the command.

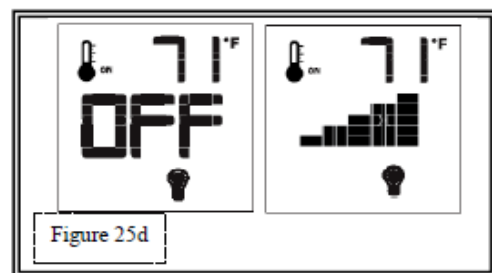

## KEY LOCK

This function locks the keys to avoid unsupervised operation.

To Activate: Press MODE and UP keys at same time.

To De-activate: Press MODE and UP keys at same time.

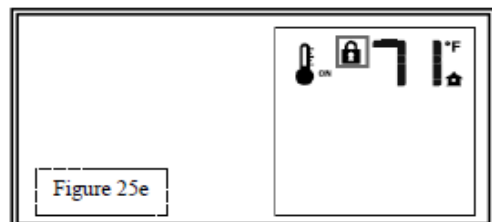



# SYSTEM OPERATION

## LOW BATTERY DETECTION

**REMOTE CONTROL:** Remote control battery lifespan depends on various factors including battery quality, number of ignitions, changes to room thermostat set point, etc. When remote control batteries are low, a Battery Icon will appear on the LCD display before all battery power is lost. When batteries are replaced this icon will disappear.

**BACKUP BATTERY PACK** (used when electrical power is interrupted): Backup batteries lifespan depends on various factors including battery quality, number of ignitions, changes to room thermostat set point, etc. When backup batteries are low, a double-beep will be emitted from the IFC control module when it receives an ON/OFF command from the remote control. This is an alert for a low battery condition of the backup batteries and after this double-beep warning, no commands will be accepted until batteries are replaced. When batteries are replaced a beep will be emitted from IFC control module as soon as powered.

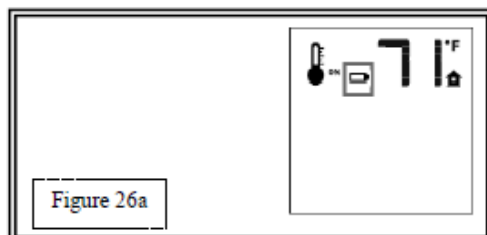

Figure 26a

## CONTINUOUS PILOT / INTERMITTENT PILOT (CPI/IPI)

This system has the option of a continuous (standing) pilot feature. This allows you to change from a spark-to-pilot system to a standing pilot system during cold weather conditions. By having the pilot on continuously, the firebox will remain warm and a draft is established in the vent, allowing the main burner to turn on with less air-flow disruption.

With system in OFF position, press Mode Key to index to CPI mode icon. Pressing the UP Arrow Key will activate the Continuous Pilot Ignition Mode (CPI). Pressing the Down Arrow Key will return to IPI. A single beep will confirm the reception of the command.

A snowflake icon will be visible during setup of either IPI or CPI modes. In IPI mode the snowflake is not visible on LCD screen. In CPI mode the snowflake will remain visible on LCD screen.

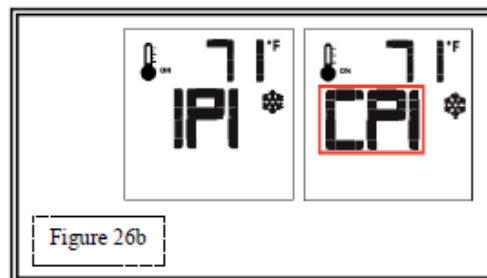

Figure 26b

## RESETTING SYSTEM FOR MANUAL OPERATION

1. Put ON/OFF switch in OFF position.
2. Press red SW1 button on IFC control module until the IFC control module emits three (3) beeps and an amber LED is illuminated, indicating the IFC control module is ready to synchronize with remote control. Within ten (10) seconds press the red SW1 button on IFC control module again. The pilot will automatically light.
3. Turn main burner on by pressing ON/OFF switch to ON position, turn off by pressing ON/OFF switch to OFF position. Pilot will remain lit even if burner is turned off.

When operating fireplace in this capacity, the only function available is burner operation on HI.

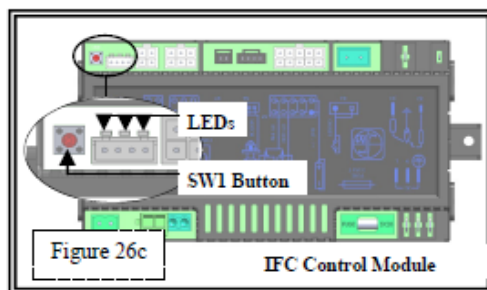

Figure 26c

IFC Control Module

## AUTOMATIC SAFETY RESTART

This system will execute an automatic turn OFF command within (24) hours of a continued pilot flame ignition. This allows the system to verify correct safety functions. After turn OFF sequence is completed, the IFC control module will re-execute the latest command.



# SYSTEM OPERATION

## S.I.T. PROFLAME 2 IFC IGNITION AND RESET INFORMATION

### IGNITION SEQUENCE

Starting from OFF, press remote control ON button. Approximately (4) seconds after ON/OFF button is pushed, the IFC control module will start the spark. First ignition try will last approximately (60) seconds.

If there is no flame ignition (rectification) during the first try for ignition, the IFC control module will stop sparking for approximately (35) seconds. After this wait time, the IFC control module will start the second try for ignition by sparking for approximately (60) seconds. If ignition is successful on third ignition attempt, there will be a (60) second delay before the main burner lights.

If after this third attempt there is still no positive ignition, the IFC control module will go into LOCK OUT and the red LED will blink (3) times in intervals until the system is reset.

**LED Indicator Location:** Corner of IFC control module. (IFC control module location determined by fireplace model and design. May be located in component housing behind lower grill, or behind left side access panel).

**LOCK OUT = LED blinks (3) times in intervals until the system is reset.**

#### In Summary:

1. The IFC control module will try (2) times for ignition.
2. Each try for ignition will last approximately (60) seconds.
3. The wait time between the two tries is approximately (35) seconds.

### RESET IFC CONTROL MODULE WHEN SYSTEM GOES INTO LOCK OUT

#### Reset Using ON/OFF Switch:

Set ON/OFF switch to OFF position. Wait approximately (2) seconds and move switch to the ON position. The ignition sequence will start again.

#### Reset Using Remote Control ON/OFF Button:

Turn the system off by pressing the remote control ON/OFF button. After approximately (2) seconds press the remote control ON/OFF button again. The IFC control module will reset and the ignition sequence will start again.

#### Reset By Cycling Flame:

In the Manual Flame Control Mode, use the Down Arrow Button to reduce flame to off (indicated by OFF displayed on Remote Control Display Screen). Wait approximately (2) seconds and press the Up Arrow Button, the ignition sequence will start.

## ADDITIONAL DIAGNOSTIC INDICATIONS INFORMATION

**Low Battery Condition (<4V) Remote Control:** Battery Icon will appear on LCD remote control display. Replace batteries.

**Low Battery Condition (<4V) Battery Backup:** Red LED Indicator will blink (1) time in intervals. Low double-beep emitted from IFC control module when it receives an ON/OFF command from the remote control. Replace Batteries.

**Pilot Flame Error Condition:** Red LED Indicator will blink (2) times in intervals. Contact your dealer if this occurs.

**System Lock Out Condition:** Red LED Indicator will blink (3) times in intervals. Make sure gas is turned on. Make sure sensor is not shorted. Follow Reset IFC Control Module When System Goes Into Lock Out instructions above.

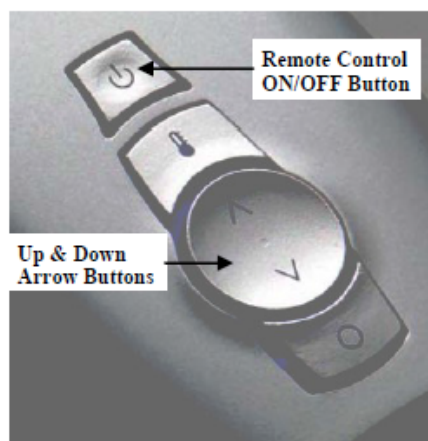
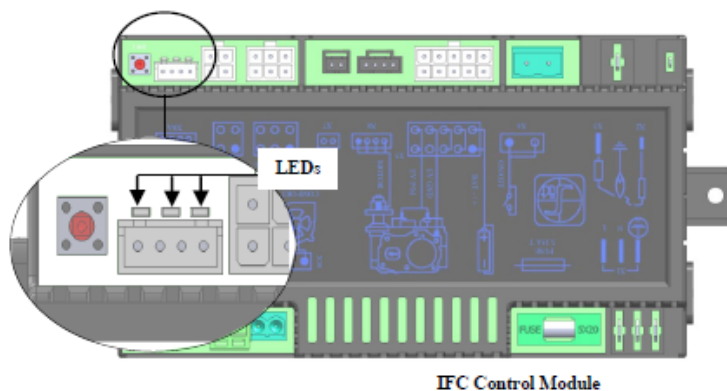

Figure 27a



IFC Control Module

# LIGHTING AND SHUTDOWN

## FOR YOUR SAFETY - READ BEFORE OPERATING

### WARNING

IF YOU DO NOT FOLLOW THESE INSTRUCTIONS EXACTLY, A FIRE OR EXPLOSION MAY RESULT, CAUSING PROPERTY DAMAGE, PERSONAL INJURY OR LOSS OF LIFE.

1. This appliance is equipped with an ignition device which automatically lights the pilot. **DO NOT** try to light the pilot by hand.
2. BEFORE OPERATING, smell all around the appliance area for gas. Be sure to smell next to the floor because some gas is heavier than air and will settle on the floor.

### WHAT TO DO IF YOU SMELL GAS:

- \* Do not try to light any appliance.
  - \* Do not touch any electrical switch; do not use any phone in your building.
  - \* Immediately call your gas supplier from a neighbor's phone. Follow the gas supplier's instructions.
  - \* If you cannot reach your gas supplier, call the fire department.
3. Do not use this appliance if any part has been under water. Immediately call a qualified service technician to inspect the appliance and to replace any part of the control system and any gas control which has been under water.

### WARNING

CHILDREN AND ADULTS SHOULD BE ALERTED TO THE HAZARDS OF HIGH SURFACE TEMPERATURES AND SHOULD STAY AWAY TO AVOID BURNS OR CLOTHING IGNITION. YOUNG CHILDREN SHOULD BE CAREFULLY SUPERVISED WHEN THEY ARE IN THE SAME ROOM AS THE APPLIANCE.

CLOTHING OR OTHER FLAMMABLE MATERIAL MUST NOT BE PLACED ON OR NEAR THE APPLIANCE.

DO NOT STORE OR USE GASOLINE OR OTHER FLAMMABLE VAPORS AND LIQUIDS IN THE VICINITY OF THIS OR ANY OTHER APPLIANCE.

### NOTE

A PAINT SMELL WILL OCCUR DURING THE FIRST FEW HOURS OF BURNING. IT IS RECOMMENDED TO LEAVE THE FAN OFF DURING THIS PERIOD TO HELP SPEED THE PAINT CURING PROCESS.

THIS FIREPLACE MAY PRODUCE NOISES OF VARYING DEGREE AS IT HEATS AND COOLS DUE TO METAL EXPANSION AND CONTRACTION. THIS IS NORMAL AND DOES NOT AFFECT THE PERFORMANCE OR LONGEVITY OF THE FIREPLACE.

**DUE TO HIGH SURFACE TEMPERATURES, KEEP CHILDREN, CLOTHING AND FURNITURE AWAY.**

This appliance needs fresh air for safe operation and must be installed so there are provisions for adequate combustion and ventilation air.

# LIGHTING AND SHUTDOWN (cont.)

## OPERATING INSTRUCTIONS

### STOP!

Read safety information on previous page and front cover of this manual before continuing.

1. Turn off all electric power to the appliance.

### ATTENTION

This appliance is equipped with an ignition device which automatically lights the pilot. **DO NOT** try to light the pilot by hand.

2. Press hand held remote **OFF** button.
3. Wait five (5) minutes to clear out any gas. Then smell for gas, including near the floor. If you smell gas, **STOP!** Follow 'WHAT TO DO IF YOU SMELL GAS' below. If you don't smell gas, go to next step.

### WHAT TO DO IF YOU SMELL GAS:

- \* Do not try to light any appliance.
- \* Do not touch any electric switch; do not use any phone in your building.
- \* Immediately call your gas supplier from a neighbor's phone. Follow the gas supplier's instructions.
- \* If you cannot reach your gas supplier, call the fire department.

4. Turn ON all electric power to the appliance.

5. Press hand held remote ON button.

### CAUTION

If fireplace will not operate, follow instructions **TO TURN GAS OFF TO APPLIANCE** and call your service technician or the gas supplier.

### NOTE

When fireplace is initially lit, condensation will appear on the glass; this is normal in all gas fireplaces and will disappear after several minutes.

## TO TURN GAS OFF TO APPLIANCE

1. Press hand held remote **OFF** button.
2. Turn OFF all electric power to appliance if service is to be performed.
3. Manual shut-off valve located behind lower grill. Turn manual shut-off valve to **OFF**.

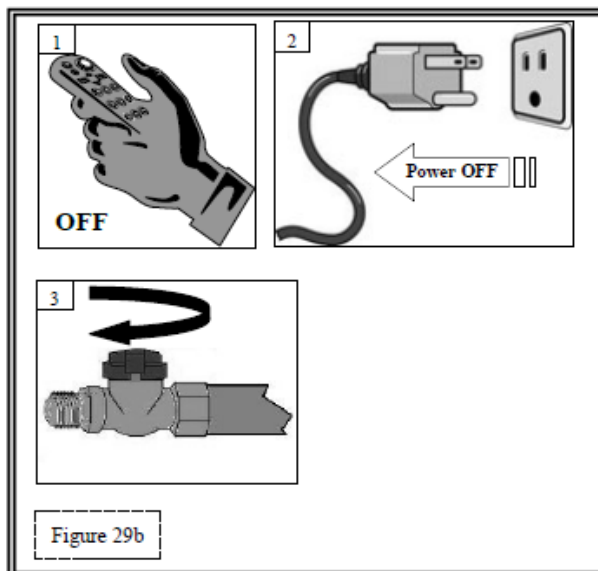
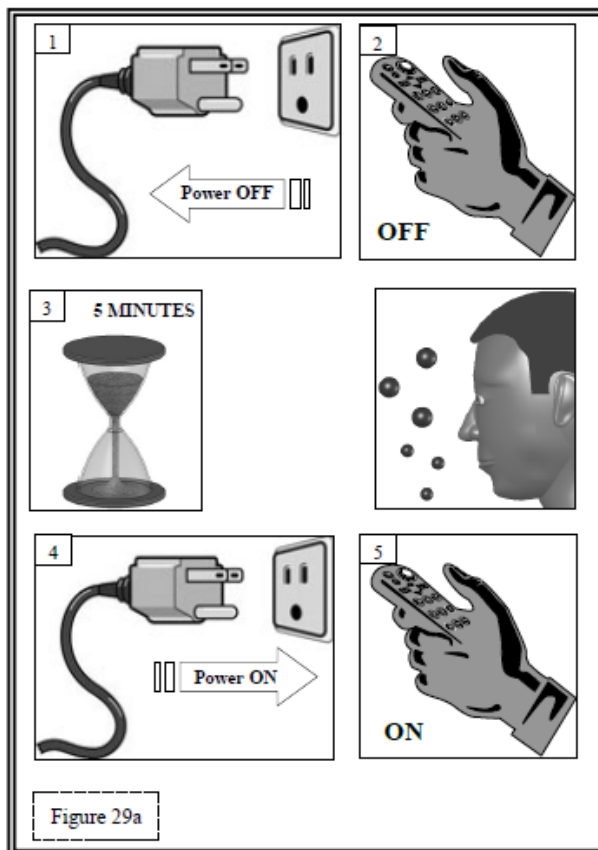

# PRESSURE TESTING

## IMPORTANT

Pressure check taps for manifold (outgoing) and inlet (incoming) pressure have been incorporated into the valve. The pressure tap marked OUT measures outgoing pressure and the pressure tap marked IN measures incoming pressure. Follow instructions below for proper testing procedures. Refer to page 14 for proper NAT and LP manifold pressures.

## NOTE

The appliance and its appliance main gas valve must be disconnected from the gas supply piping system during any pressure testing of that system at test pressures in excess of 1/2 psi (3.5 kPa). The appliance must be isolated from the gas supply piping system by closing its equipment shutoff valve during any pressure testing of the gas supply piping system at test pressures equal to or less than 1/2 psi (3.5 kPa).

## INLET PRESSURE TEST:

1. Loosen inlet (IN) pressure tap screw (counter-clockwise).
2. Attach manometer using a 1/14" I.D. hose.
3. Light pilot and burner. Check pressure to ensure it is between the min. and max. recommended pressure settings.
4. Turn off burner and pilot.
5. Disconnect hose and tighten screw (clockwise). Screw should be snug, do not over tighten.
6. Relight pilot and burner. Reattach manometer to inlet pressure tap to verify that it is completely sealed. Manometer should read no pressure.

## NOTE

If inlet pressure reading is too high or too low, contact the gas company. Only a qualified gas service technician should adjust incoming gas pressure.

## CAUTION

A LOW PRESSURE READING CAN CAUSE DELAYED IGNITION.

## MANIFOLD PRESSURE TEST:

1. Light pilot.
2. Loosen manifold (OUT) pressure tap screw (counter-clockwise).
3. Attach manometer to pressure tap using a 1/4" I.D. hose.
4. Light pilot and burner. Check manometer reading.
5. Turn burner and pilot off.
6. Disconnect manometer hose and tighten screw (clockwise). Screw should be snug, do not over tighten.
7. Attach manometer to manifold pressure tap to verify it is completely sealed. Manometer should read no pressure when pilot and burner are on.

Outlet (Manifold) Pressure Screw

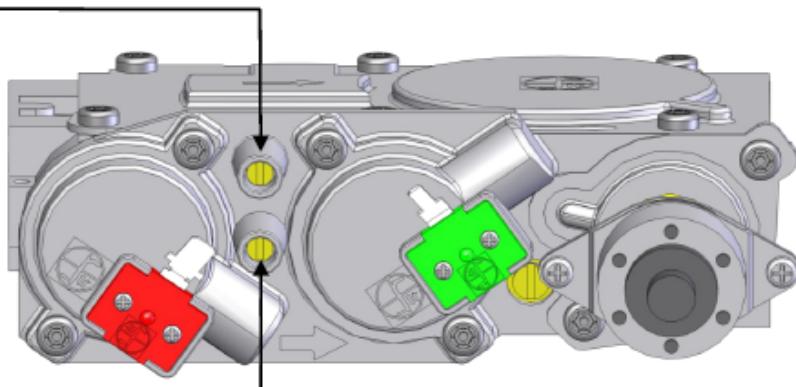

Figure 30a

Inlet Pressure Screw



# FINALIZING THE INSTALLATION

## FLAME APPEARANCE:

Flame appearance is affected by several factors including altitude, venting configuration and fuel quality. Although the venturi setting has been factory set, adjustments may be necessary for optimal performance and visual aesthetics.

When fireplace is first lit, the flames will be blue. Flames will gradually turn yellowish-orange during first 15 minutes of operation. If flames remain blue, or become dark orange with evidence of sooting (black tips), the burner tube venturi may need adjustment.

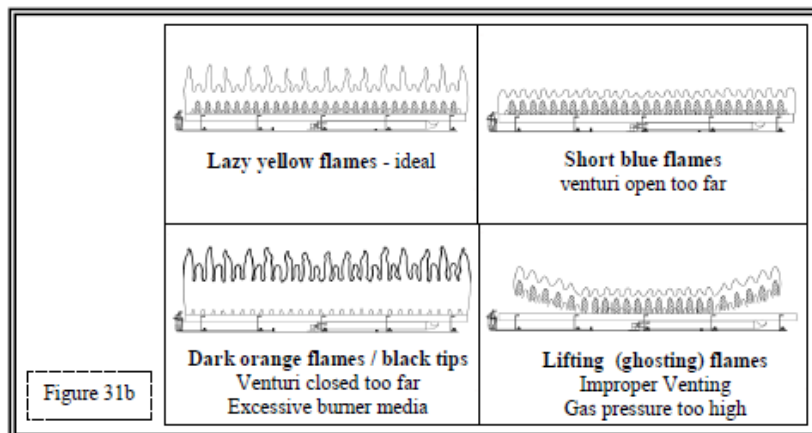
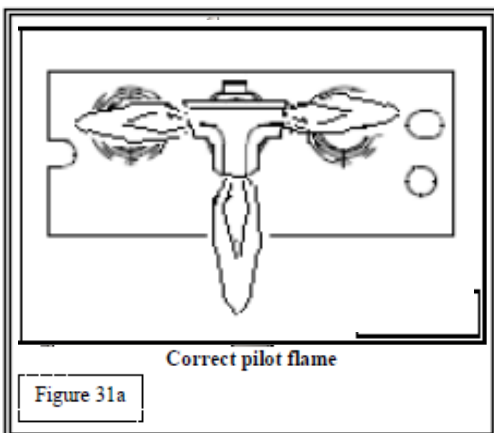

**WARNING** Burner tube adjustable venturi positioning should only be performed by a qualified professional service technician.

### FACTORY SET BURNER TUBE VENTURI SETTINGS (ADJUST AS NECESSARY FOR YOUR INSTALLATION)

|              | NATURAL GAS     | LP (PROPANE) GAS |
|--------------|-----------------|------------------|
| FRONT BURNER | 100% CLOSED     | 5/8" (16mm) OPEN |
| BACK BURNER  | 1/8" (3mm) OPEN | 5/8" (16mm) OPEN |

### BURNER TUBE VENTURI ADJUSTMENT GUIDELINES

| VENTURI POSITION | FLAME COLOR                       | VENTURI ADJUSTMENT             |
|------------------|-----------------------------------|--------------------------------|
| Closed too far   | Dark orange flame with black tips | Open venturi setting slightly  |
| Open too far     | Blue flames                       | Close venturi setting slightly |

**NOTE** If soot is present, check log positioning before adjusting burner venturi. Logs must not block burner ports.

**IMPORTANT** SLIGHT ADJUSTMENTS TO BURNER VENTURI OPENING CREATE DRAMATIC RESULTS. ADJUST AT SLIGHT INCREMENTS UNTIL DESIRED LOOK IS ACHIEVED. ALWAYS BURN FIREPLACE FOR AT LEAST 15 MINUTES AND ALLOW TIME TO COOL BEFORE MAKING ANY FURTHER ADJUSTMENTS.

**NOTE** Front burner venturi generally does not require adjustment unless installing a gas conversion kit.

## TO ADJUST BACK (MAIN) BURNER VENTURI:

**WARNING** To avoid property damage or personal injury, allow fireplace time to cool before making any adjustments.

Back (main) burner venturi adjustment handle is attached to underside of control board. Access through lower grill opening. Loosen wing nuts, adjust as necessary, pulling handle forward to open, pushing backwards to close. Tighten wing nuts.

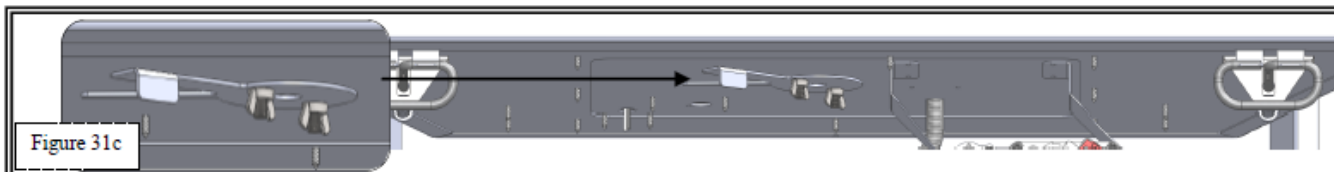



# FINALIZING THE INSTALLATION

This fireplace is shipped with the restrictor in the open position. After installation it may be necessary to make adjustments to this setting. Turn fireplace on and allow to burn for 15 minutes before determining if flames indicate there is excessive draft (flickering, short flames) or, if flames indicate insufficient draft (lifting or ghosting flames).

## RESTRICTOR TROUBLESHOOTING

| FLAME APPEARANCE     | DRAFT PROBLEM                             | RESTRICTOR SOLUTION |
|----------------------|---|---------------------|
| Short, flickering    | Excessive draft - not enough restriction  | Close restrictor    |
| Lifting or ghosting* | Insufficient draft - too much restriction | Open restrictor     |

\* Improper venting installation may cause flames to lift or "ghost" - a dangerous situation. Inspect flames after installation to ensure proper performance. If determined that venting is correct, and the restrictor has been opened, yet flames are still lifting or ghosting, shut off gas supply to fireplace and call a qualified service technician.

## RESTRICTOR ADJUSTMENT:

### WARNING

TO AVOID PROPERTY DAMAGE OR PERSONAL INJURY, ALLOW FIREPLACE AMPLE TIME TO COOL BEFORE MAKING ANY ADJUSTMENTS.

Restrictor setting adjustment handle is located at top front of firebox. Remove glass frame assembly to access. Loosen screw, adjust setting, tighten screw and reinstall glass frame assembly.

### RECOMMENDED RESTRICTOR SETTINGS

| VENTING                       | RESTRICTOR POSITION                 |
|-------------------------------|-------------------------------------|
| Min. - 20ft. (6.1m)           | FULL OPEN (handle pulled forward)   |
| 20 ft. (6.1m) - 35ft. (10.7m) | PARTIAL OPEN (handle set to center) |
| 35ft. (10.7m) - 50ft. (15.2m) | CLOSED (handle pushed back)         |

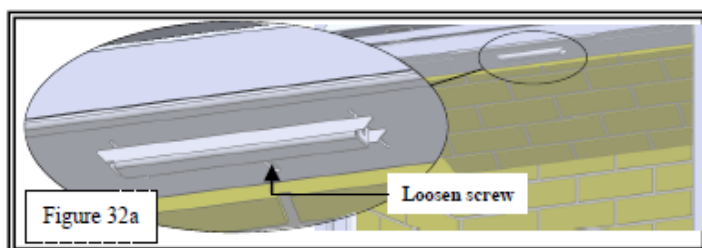

# MAINTENANCE

The appliance is required to be inspected at least once a year by a professional service person.

The compartment below firebox must be cleaned at least once a year, more frequent cleaning may be required due to excessive lint from carpeting, bedding materials, or other fibrous materials. Use a vacuum to clean all components at least once a year.

## NOTE

INSTALLATION AND REPAIR SHOULD BE DONE ONLY BY QUALIFIED SERVICE PERSON. THE APPLIANCE SHOULD BE INSPECTED BEFORE USE AND ANNUALLY BY A QUALIFIED SERVICE PERSON. MORE FREQUENT CLEANING MAY BE REQUIRED DUE TO EXCESSIVE LINT FROM CARPETING, BEDDING MATERIALS, ETC. IT IS IMPERATIVE THAT CONTROL COMPARTMENTS, BURNERS AND CIRCULATION AIR PASSAGEWAYS OF THE APPLIANCE BE KEPT CLEAN.

## CONTROL BOARD SYSTEM

- Annual cleaning of burner system is required. Vacuum all components thoroughly.
- Visually check for blocked port holes, especially near the pilot. Blocked port holes may cause delayed ignition.
- Visually check pilot light and burner when in operation. Flames should be steady, not lifting or floating.

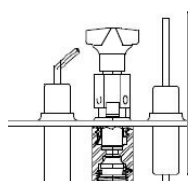

Pilot

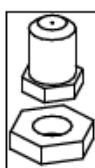

Burner Orifice

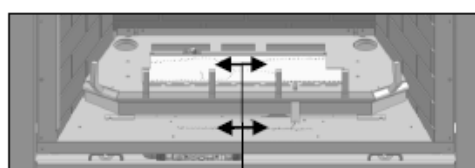

Burner Ports

Figure 33a

## FAN

The fan should be disconnected from electrical current, and cleaned (vacuumed) every six months. The bearings are sealed and require no oiling.

## VENT SYSTEM

Annual examination of venting system by a qualified agency is required.

IF VENT-AIR INTAKE SYSTEM IS DISASSEMBLED FOR ANY REASON, RE-INSTALL PER INSTRUCTIONS PROVIDED WITH INITIAL INSTALLATION.

The flow of combustion and ventilation air must not be obstructed.

## GLASS CLEANING & REPLACEMENT

- Clean glass only when cool and only with non-abrasive cleansers.  
WARNING: DO NOT OPERATE APPLIANCE WITH GLASS/FRAME ASSEMBLY REMOVED, CRACKED OR BROKEN. REPLACEMENT OF THE GLASS SHOULD ONLY BE PERFORMED BY A LICENSED OR QUALIFIED SERVICE PERSON.
- Use protective gloves to handle any broken or damaged glass assembly components.
- The glass assembly, part #INT-057T, shall only be replaced as a complete unit, as supplied by Hussong Mfg. Co., Inc.
- Replacement of glass & frame assembly, part #INT-057T, must only be performed by a licensed or qualified service person.  
DO NOT SUBSTITUTE MATERIALS.
- Do not strike or slam glass door assembly.

## IMPORTANT

ANY SAFETY SCREEN OR GUARD REMOVED FOR SERVICING MUST BE REPLACED PRIOR TO OPERATING THE APPLIANCE.

## CAUTION

LABEL ALL WIRES PRIOR TO DISCONNECTION WHEN SERVICING CONTROLS. WIRING ERRORS CAN CAUSE IMPROPER AND DANGEROUS OPERATION. VERIFY PROPER OPERATION AFTER SERVICING.

KEEP APPLIANCE AREA CLEAR OF COMBUSTIBLE MATERIALS, SUCH AS GASOLINE AND OTHER FLAMMABLE VAPORS AND LIQUIDS.

# TROUBLESHOOTING

**ATTENTION** TROUBLESHOOTING MUST BE PERFORMED BY A QUALIFIED TECHNICIAN.

Before proceeding with the steps in the following troubleshooting guide, verify the power supply is present and receiver batteries and/or battery pack are fresh and installed with correct polarity.

Make sure all connections between wire harnesses and system components are proper and positive.

Make sure communication link between remote control and IFC control module is established.

Verify inlet pressure meets the recommended inlet pressure. If necessary adjust line pressure regulator.

## PILOT WILL NOT LIGHT / STAY LIT

- Electrical power interrupted or disconnected. Restore electrical power to fireplace or use battery back-up. Ensure batteries are fully charged if using battery back-up as power source.
- Verify gas supply is turned on. Check remote shut-off valves from fireplace. Usually there is a valve near the main. There may be more than (1) valve between the fireplace and the main.
- Low gas pressure. Low gas pressure can be caused by several situations such as a bent line, too narrow diameter pipe, or low line pressure. Consult with plumber or gas supplier.
- No LP in tank. Check LP (propane) tank. Refill if necessary.
- Wiring disconnection. Use wiring schematic in this manual to determine that all wiring connections are secure and correct.
- Pilot flame not making contact with flame rectification sensor on pilot assembly. This valve is equipped with a pilot flame adjustment screw. Adjust as necessary.
- Pilot adjustment screw not sealed. Seal pilot adjustment screw. Do not over tighten.

## PILOT FLAME ALWAYS ON / WILL NOT EXTINGUISH

- System set to CPI mode. Set system to IPI mode.

## MAIN FLAME WILL NOT LIGHT

- ON/OFF rocker switch in OFF position. Switch to ON position.
- Remote not working properly. Replace batteries.
- Remote set to thermostat mode and there is no call for heat. Adjust heat setting.
- Thermostat disconnected or set too high. Set thermostat to lower temperature setting.
- Ensure pilot flame will ignite. If not, see pilot flame troubleshooting above.
- Ensure pilot flame is properly located to ignite main flame.
- Plugged main burner orifice.
- Wiring disconnection / improper wiring. Check for faulty or incorrect wiring.
- Verify gas supply is turned on.
- Low gas pressure. Low gas pressure can be caused by several situations such as a bent line, too narrow diameter pipe, or low line pressure. Consult with plumber or gas supplier.

# TROUBLESHOOTING

## PILOT AND BURNER EXTINGUISH WHILE IN OPERATION

- No LP in tank. Check and refill if necessary.
- Glass frame assembly not installed correctly. Refer to corresponding instructions in this manual.
- Improper vent cap installation. Adjust if necessary.
- Vent cap blockage. Remove debris if necessary.
- Improper pitch on horizontal vent. 1/4" (6mm) rise per foot is required on horizontal venting.
- Inner vent pipe leaking exhaust gases back into firebox. Check for leaks and repair if necessary.
- Excessive draft.

## GLASS SOOTING

- Improper log placement. Refer to corresponding pages in this installation manual.
- Improper venturi setting. Venturi may need to be opened slightly to allow more air into the gas mix.
- Improper pitch on horizontal venting. 1/4" (6mm) rise per foot required on horizontal venting.

## FLAME BURNS BLUE AND LIFTS OFF BURNER

- Improper venturi setting. Venturi may need to be closed slightly.
- Improper vent cap installation. Check for proper vent cap installation.
- Blockage or vent system leaks.

## NO REACTION TO COMMAND

- Backup battery pack batteries or remote control batteries low. Replace batteries.
- No communication between remote control and IFC control module. Reprogram remote control to IFC control module. Follow INITIALIZING THE SYSTEM FOR THE FIRST TIME as outlined in this manual.
- A maximum number of failed ignitions or flame restorations have been reached. Reset IFC control module.

### **Reset Using ON/OFF Switch:**

Set ON/OFF switch to OFF position. Wait approximately (2) seconds and move switch to the ON position. The ignition sequence will start again.

### **Reset Using Remote Control ON/OFF Button:**

Turn the system off by pressing the Remote Control ON/OFF button. After approximately (2) seconds press the Remote Control ON/OFF button again. The IFC control module will reset and the ignition sequence will start again.

### **Reset By Cycling Flame:**

In the Manual Flame Control Mode, use the Down Arrow Button to reduce flame to off (indicated by OFF displayed on Remote Control Display Screen). Wait approximately (2) seconds and press the Up Arrow Button, the ignition sequence will start.



# CONVERSION KIT INSTRUCTIONS

Part # UA2000: NG - LP Conversion Kit

/

UA2100: LP - NG Conversion Kit

## WARNING

This conversion kit shall be installed by a qualified service agency in accordance with the manufacturers instructions and all applicable codes and requirements of the authority having jurisdiction. If the information in these instructions is not followed exactly, a fire, explosion or productions of carbon monoxide may result, causing property damage, personal injury or loss of life. The qualified service agency is responsible for proper installation of this kit. The installation is not proper and complete until operation of the converted appliance is checked as specified in the manufacturer's instructions supplied with the kit. Refer to appliance owner's manual or product data plate for proper inlet and manifold pressure adjustments and orifice sizing.

Kit includes: (1) Gas Conversion Label (2) Burner Orifices LP #49 & 62 / NG #33 & #56 (301-0068)  
(1) Step Motor Pressure Regulator (308-6018 (LP) & 308-6010 (NG) )

## CAUTION

THE GAS SUPPLY SHALL BE SHUT OFF PRIOR TO DISCONNECTING THE ELECTRICAL POWER, BEFORE PROCEEDING WITH THE CONVERSION.

## WARNING

SHUT OFF GAS SUPPLY AND ELECTRIC POWER TO FIREPLACE.  
SHUT OFF GAS SUPPLY BEFORE DISCONNECTING ELECTRIC POWER.

## IMPORTANT

For high altitude installations: Above 2000ft. (610m) US / 4500ft. (1372m) Canada, consult the local gas distributor or authority having jurisdiction for proper de-rating methods.

### PREPARE THE FIREPLACE:

1. Remove upper hood, upper louver, glass assembly\*.
2. Remove logs\*.
3. Remove back burner assembly from fireplace\*.
4. Loosen screws securing front orifice bracket, pull orifice backwards out of front venturi.

### REPLACE BURNER ORIFICE:

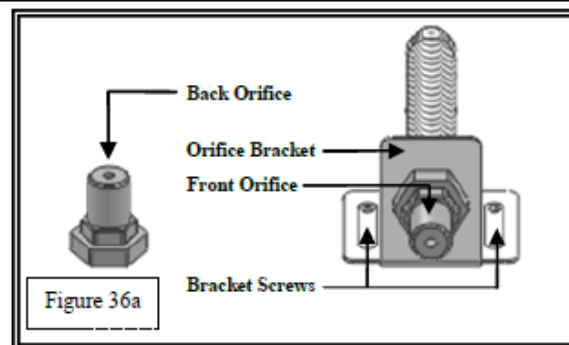

Remove existing orifice caps. Replace with orifice caps included with kit, making sure to tighten caps securely.

Front burner orifice: (NAT #56 / LP #62

Back burner orifice: (NAT #33 / LP #49

## PILOT CONVERSION

Using a 7/16" wrench and loosen the pilot hood 1/4 turn. Slide the tab at the bottom of the orifice hood all the way so the red side (propane) with the hole in it is showing. Tighten the pilot hood back up so that it is lined up with the two probes on both sides of the pilot assembly.





# CONVERSION KIT INSTRUCTIONS

## CONVERT THE GAS CONTROL VALVE:

Follow stepper motor pressure regulator instruction sheet included with conversion kit to convert gas valve. (LP or NAT marked on stepper motor pressure regulator).

## COMPLETE THE CONVERSION:

1. Adjust front burner venturi setting by loosening screw, adjusting cap and retightening screw. NAT: 100% closed / LP: 5/8" (16mm) open
2. Reinstall front burner. Pull front orifice bracket forward until orifice is properly seated in front venturi. Tighten screws\*. Figure 37a.
3. Re-install back burner assembly into fireplace, checking to ensure burner venturi is properly seated over burner orifice\*. Figure 37a.
4. Back (main) burner venturi adjustment handle is attached to underside of control board. Access through lower grill opening. Loosen wing nuts, adjust as necessary, pulling handle forward to open, pushing backwards to close. Tighten wing nuts.  
NAT: 1/8" (3mm) open - handle pushed back  
LP: 5/8" (16mm) open - handle pulled forward
5. Re-install logs\*.
6. Turn on gas and electrical supplies.
7. Light fireplace\*. Check for leaks at all connections with a gas leak detector, whether field or factory made.
8. Test inlet pressure\*.
9. Visually check pilot flame. Flame should envelope top of flame sensor and extend onto burner far enough for proper ignition.

To Adjust Pilot: Turn pilot adjustment screw clockwise to decrease or counter-clockwise to increase pilot flame.

10. Turn fireplace off.
11. Affix gas type sticker to existing label.
12. Reinstall glass frame assembly, upper louver and upper hood\*.
13. Complete and affix Gas Conversion label behind lower grill.

\*REFER TO CORRESPONDING PAGES IN THIS INSTALLATION MANUAL IF NECESSARY.

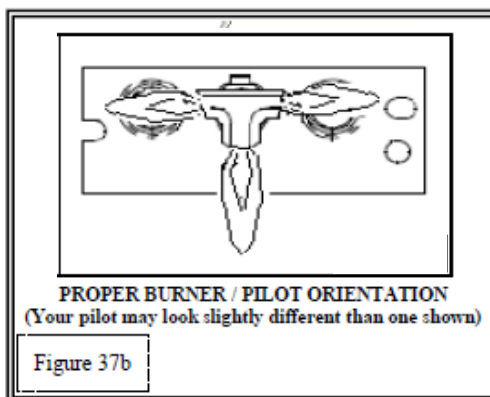
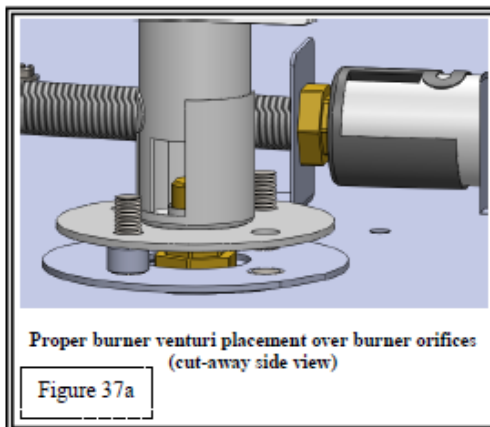

Fireplace Model No.: \_\_\_\_\_

This appliance and control was converted on \_\_\_\_\_ to \_\_\_\_\_ gas with Kit No. \_\_\_\_\_ by \_\_\_\_\_

Company: \_\_\_\_\_

Address: \_\_\_\_\_

Which accepts responsibility that this conversion has been properly made.

Minimum / Maximum inlet pressures: Refer to rating plate

Manifold Pressure: Refer to rating plate

Orifice size: \_\_\_\_\_ Input Rating: \_\_\_\_\_ BTU

Complete and affix as close as possible to rating plate.

**GAS CONVERSION LABEL**  
(included with conversion kit)

Figure 37c

## REPLACEMENT PARTS LIST (UF0100)

| Item #       | Item Description   | Unit |
|--------------|--|------|
| 200-0100     | Owner's Manual   |      |
| 314-0009     | Glass Gasket (125 inches required)                                     |      |
| 308-6011     | SIT Pro Flame II Electronic Control Module                             |      |
| 308-6014     | SIT Pro Flame II Handheld Transmitter                                  |      |
| 308-6027     | SIT 885 Gas Valve c/w Step Motor (0.885.009)                           |      |
| 305-6002     | Module Main Wiring Harness (5 wire)                                    |      |
| 305-6003     | Valve Wiring Harness (4 wire)  |      |
| 305-0060     | Battery Back-up  |      |
| 301-0068     | Orifice (Main Burner Orifice) Drill to # 56 & #31 DMS for Natural Gas  |      |
| 301-0068     | Orifice (Main Burner Orifice) Drill to # 63 & #48 for LP (Propane) Gas |      |
| 308-0123     | Pilot Assembly, conv. PSE IPI (SIT connections)                        |      |
| UA8100       | Burner Assembly - Log Burner   |      |
| UA-8010      | Door Assembly  |      |
| 305-6301     | Light Socket (120V / 1000W)  |      |
| 305-6302     | Light Bulb (120V / 50W)  |      |
| UA2100       | Conversion Kit LP to NG  |      |
| UA2000       | Conversion Kit NG to LP  |      |
| 305-0224     | Replacement Blower   |      |
| 754-0057     | Upper Hood   |      |
| 754-0065     | Eye Brow ( low profile hood used with door kits)                       |      |
| 754-0058     | Top Louver   |      |
| TBA          | Lower Louver Assembly  |      |
| UA0150       | Refractory Panel Set (4 pc.)   |      |
| UA0150LS     | Left Side Panel  |      |
| UA0150RS     | Right Side Panel   |      |
| UA0150T      | Top Panel  |      |
| UA0150R      | Rear Panel   |      |
| 310-U501     | Complete 12pcs Log Set   |      |
| 310-U501-1   | LOG # 1  |      |
| 310-U501- 2  | LOG # 2  |      |
| 310-U501- 3  | LOG # 3  |      |
| 310-U501- 4  | LOG # 4  |      |
| 310-U501- 5  | LOG # 5  |      |
| 310-U501- 6  | LOG # 6  |      |
| 310-U501- 7  | LOG # 7  |      |
| 310-U501- 8  | LOG # 8  |      |
| 310-U501- 9  | LOG # 9  |      |
| 310-U501- 10 | LOG # 10   |      |
| 310-U501- 11 | LOG # 11   |      |
| 310-U501- 12 | LOG # 12   |      |
| 310-0020     | Black Embers   |      |
|              |  |      |

# LIMITED WARRANTY

## LIMITED 10 YEAR WARRANTY

This limited 10 Year Warranty will not become effective until the Warranty Registration Form has been completed and mailed to Archgard Fireplace Products 7116 Beatty Drive, Mission, BC V2V 6B4 Canada. This registration form must be received within 30 days of installation. Failure to do so may result in delayed warranty coverage and submission of proof of purchase will be required.

Archgard Fireplace Products warranties to the original purchaser of this Ambiance Fireplace, that is free from defects in materials and workmanship at the time of manufacture.

Subject to the following conditions & requirements, Archgard Fireplace Products extends the following limited warranty under normal use and service, with respect to the Ambiance line of gas burning fireplaces.

**YEAR 1:** subject to the conditions & requirements listed below, within the first year from date of purchase, Archgard Fireplace Products shall, at it's de-discretion, replace or repair any such defect in material or workmanship at Archgard Fireplace Product's expense, including reasonable labor costs to repair or replace the defective component, if a factory pre-authorization is give for the repair.

**YEARS 2-10:** subject to the conditions and requirements listed below, beginning with the first day of the second year and continuing through the tenth year, Archgard Fireplace Products, will at it's discretion, provide repair or replacement parts at current list prices for any defect in materiel or workmanship of components, including optional components and accessories (if available). Archgard Fireplace Products shall not be responsible for any installation, labor, transportation of other indirect cots.

## LIMITATION OF LIABILITY

To make a claim under this warranty, the purchaser must first contact the dealer/installer from whom the fireplace was purchased.

This limited warranty will be void if the fireplace is not installed by a qualified installer and according to the installation instructions. Use of unauthorized components will make this warranty null and void.

This limited warranty also is void if the fireplace is not operated, at all times, according to the operating instructions furnished.

This warranty is limited to defects in material and workmanship. It does not apply to any product that has been subject to negligence, misapplication, improper installation.

No person is authorized to extend the time of this warranty or to accept on Archgard Fireplace Product's behalf any additional obligation of liability connected with the unit.

It is expressly agreed and understood that this warranty is Archgard Fireplace Product's sole obligation and purchaser's exclusive remedy for defective fireplace equipment. Archgard Fireplace Products shall not be liable for any consequential, incidental or contin-gent damages whatsoever. The forgoing warranty is exclusive and in lieu of all other express warranties. Archgard Fireplace Prod-ucts shall not be held to implied warranties or merchantability and fitness for a particular purpose. This warranty replaces all previ-ous warranty policies.

Some states do not allow the exclusion or limitation of incidental or consequential damages or limitations on how long an implied warranty lasts, so the above limitations or exclusions may not apply to you. This warranty gives you specific legal rights and you may also have other rights which vary from state to state.

Archgard Fireplace Products reserves the right to make changes at any time, without notice, in design material, specifications and prices. Archgard Fireplace Products reserves the right to discontinue models and product.

## WARRANTY CONDITIONS & REQUIREMENTS:

1. You are the original purchaser. This warranty is not transferable.
2. Installation of the fireplace is performed by a qualified installer.
3. Installation and operation must comply with installation and operation instructions.
4. Paint and glass gaskets are covered for 30 days from date of purchase.
5. Remote controls and all optional accessories are covered for 1 year from date of purchase.
6. This warranty does not offer coverage for Light Bulbs or Batteries (whether factory, dealer or installer supplied). This includes any damage stemming from either component's nonuse.
7. Components broken, (including glass panels), during shipping, careless handling of components, or defects resulting from improper installation, misuse of the fireplace and components are not covered under this warranty.
8. This warranty does not cover any part of the fireplace or any components which have been exposed to or submerged under water.
9. Archgard Fireplace Products must be notified by the dealer the fireplace was purchased from or a qualified installer/service technician of the defect.
10. Annual service of the fireplace as required in the installation manual, is performed by a qualified installer/service technician. (Copies of such service records may be required to claim a warranty).
11. All previous warranty/service has been performed by a qualified installer or service technician. (Copies of such service records may be required to claim a warranty).



# LIFETIME WARRANTY

## LIFETIME WARRANTY

**THIS LIFETIME WARRANTY COVERAGE WILL BE EXTENDED AS DESCRIBED BELOW PROVIDED ALL WARRANTY CONDITIONS AND REQUIREMENTS ARE MET AS OUTLINED IN THE 10 YEAR LIMITED WARRANTY POLICY.**

### LIFETIME WARRANTY COVERAGE

LIFETIME WARRANTY IS EXTENDED AS FOLLOWS: Archgard Fireplace Products warrants the original purchaser that the firebox, heat exchanger, fiber logs, burner tube and glass panel of this Ambiance Fireplace will not be defective in material or workmanship under normal use and service for as long as you own this product. If any of these components fail due to defects in material and workmanship under normal use and service Archgard Fireplace Products will, at its sole discretion, repair or replace the defective component. This LIFETIME WARRANTY does not cover any installation, labor, transportation or other indirect cost arising from defective components.

### LIMITATION OF LIABILITY

This Lifetime Warranty will be void if the fireplace is not installed by a qualified installer and according to the installation instructions. Use of unauthorized components will make this warranty null and void. This Lifetime Warranty also is void if the fireplace is not operated, at all times, according to the operating instructions furnished. This warranty is limited to defects in material and workmanship of components specified. It does not apply to any product that has been subject to negligence, misapplication, improper installation.

No person is authorized to extend the time of this warranty or to accept on Archgard Fireplace Product's behalf, any additional obligation of liability connected with the unit.

Archgard Fireplace Products may fully discharge all obligations with respect to this Lifetime Warranty by refunding the wholesale price of the defective component(s).

It is expressly agreed and understood that this Lifetime Warranty is Archgard Fireplace Product's sole obligation and original purchaser's exclusive remedy for defective fireplace equipment. Archgard Fireplace Products shall not be liable for any consequential, incidental or contingent damages whatsoever other than those incurred by Archgard Fireplace Products to repair or replace the defective component. The foregoing warranty is exclusive and in lieu of all other expressed warranties. Archgard Fireplace Products shall not be held implied warranties, including but not limited to the implied warranties or merchantability and fitness for a particular purpose. This lifetime warranty replace all previous lifetime warranty policies.

Archgard Fireplace Products reserves the right to make changes at any time without notice, in design, material, specifications and prices. Archgard Fireplace Products reserves the right to discontinue models and products.

To activate this Lifetime Warranty coverage, this registration card must be completed and mailed within 30 days of installation to the following address:

**ARCHGARD FIREPLACE PRODUCTS  
7116 BEATTY DRIVE  
MISSION, BC V2V 6B4  
CANADA**

Effective March 2015

CUT ALONG DOTTED LINE

**PURCHASER NAME:** \_\_\_\_\_

**INSTALLATION DATE:** \_\_\_\_\_

**ADDRESS:** \_\_\_\_\_

**MODEL #:** \_\_\_\_\_

**SERIAL #:** \_\_\_\_\_

**TELEPHONE:** \_\_\_\_\_

**INSTALLER NAME:** \_\_\_\_\_

**ADDRESS:** \_\_\_\_\_

**TELEPHONE:** \_\_\_\_\_