

# FP30 ARCH

**FIREPLACE**  
FOR LARGE SPACES

Heat Output Cord Wood  
**99,000 BTU**

38,500 BTU EPA Test Fuel

EFFICIENCY (LHV)	76.8%
EMISSIONS	2.47 GM/HR.
LOG SIZE (MAX)	18-20 INCHES
FIREBOX SIZE	3.0 CU.FT.
GLASS SIZE	246 SQ.IN.
WEIGHT	APPROX. 626 LB.

**NEW DESIGN AND CLEARANCES FOR 2015**

Enjoy the full size and performance of the FP30 ARCH zero clearance fireplace with a classic arched door to complement traditional homes. With uncompromised features and performance; a floating firebox of heavy gauge steel, high capacity baffle system, and EBT2 extended heat technology, the FP30 Arch meets the need for high-capacity wood heat, with the space savings and convenience of a wall-mounted fireplace.

Homeowners can supplement their heat source with an optional Heat Distribution System with the FP30 ARCH. Each heat duct is independently switch controlled, transferring heat into isolated rooms, and allowing for on demand control and comfort.

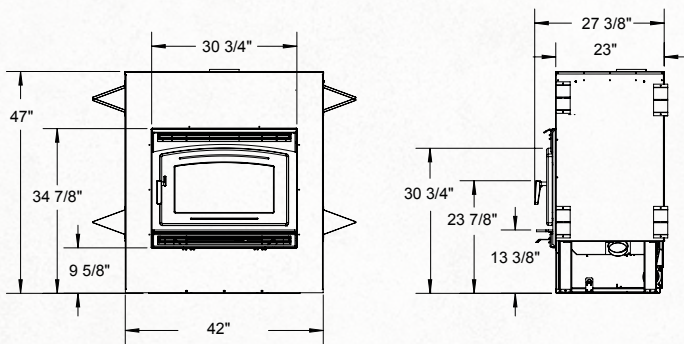

**STANDARD FEATURES**

- Reliable, durable non-catalytic technology
- Air wash system for super clean ceramic glass
- Boost air for easy lighting
- Oversize glass viewing window
- Floating firebox for extended stove life
- 304 Stainless Steel Baffle, insulation cover, rails and flame shield
- High-tech multi-port combustion air injection system
- Extended Burn Technology (EBT2)
- Integrated heat exchanger
- North-South loading
- 2x80 cfm temperature actuated blowers
- Single-Lever Air Control
- Cast iron door with ash lip (Contemporary)
- Inside and outside combustion air capable
- Mobile Home Approved
- EPA Certified

**PERFORMANCE OPTIONS**

EPA Certified Powered Heat Distribution System



For reference only. Installations should be based on installation manuals. Specifications subject to change.